

OREGON CORNER RESTORATION FORM

COUNTY: Umatilla DATE: 06/09/97

CORNER DESIGNATION: N-13, The Northwest Corner of Section 22, T4N., R35E., W.M.

PREVIOUS RENEWALS/SURVEYS, ETC.: Corner established by William H. Odell, GLO Contract No. 114, dated July 2, 1866. Survey notes state: Set post Cor. for Secs. 15, 16, 21 & 22; drove charred stake, dug pits and raised mound as per instructions.

This corner was re-established by Arnold in County Survey No. 25 dated 1887, and verified by Arnold in Survey to subdivide Section 16, dated October 1889 (Book 1, Pages 221-225).

Corner position was calculated per Survey No. 83-156-C. but most recent retracement record, i.e., Record 9 and Record 8, shown on map of this survey were not used.

MONUMENT AND ACCESSORIES FOUND: None. This corner was re-established by double proportion measurement between the Northwest corner of Section 15, the North Quarter Corner of Section 22, the Southwest corner of Section 22 and the North Quarter Corner of Section 21, using retracement record distances reported on County Survey No. 25, (Arnold, 1887), and Survey to subdivide Section 16, by Arnold, dated October 1889 and reported in Record of Private Surveys, Book 1, Pages 221-225.

MONUMENT MARKING DETAIL:

T4N R35E
 S16|S15
 S21|S22
 1997
 PLS 1106

MONUMENT SET:

A 2 1/2" brass cap on a 1" x 30" galvanized iron pipe, 20" below the surface of cultivated field, marked as shown in monument marking detail.

New Accessories:

A 5/8" x 24" iron rod with a yellow plastic cap marked "OR PLS 1106, WA PLS 17372" bears N 50° E, 18.4 feet.

A 5/8" x 24" iron rod with a yellow plastic cap marked "OR PLS 1106, WA PLS 17372" bears S 39° E, 23.3 feet.

A 5/8" x 24" iron rod with a yellow plastic cap marked "OR PLS 1106, WA PLS 17372" bears S 30° W, 24.7 feet.

A 5/8" x 24" iron rod with a yellow plastic cap marked "OR PLS 1106, WA PLS 17372" bears N 57° W, 23.9 feet.

Bearing object signs attached to all iron rods and snow barriers. Steel fence post approximately 5 feet North of monument with witness sign attached.

LOCATION & COMMENTS: Corner is located in cultivated fields.

COMPASS DECLINATION: 18° East

Surveyor's Seal

Witnesses: Kelly Snively
 Jason Wells

OREGON NORTH STATE PLANE CO-ORDINATE
 FOR CORNER, NAD 83(91), INT. FEET:

N: 791540.80
 E: 8728372.22

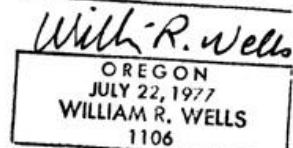
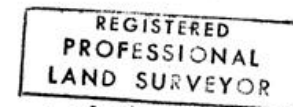

Renews 6-30-98

97-141-C