

LAND CORNER RECORD

LL 5680.2

1. T 3N R 37E No. A 9 Cor. Sec. Mer. Will State Oregon (Rectangular) N. F. Umatilla Dist. Pendleton

2. Corner Status

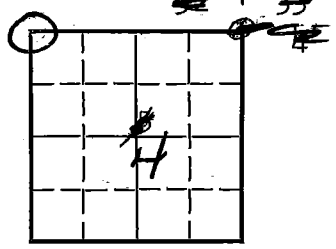

3. Original Description Resurvey Vol. _____ Page _____ Where Recorded GLO year 1879

4. Description of Corners: Post (still standing)
Original witness trees as described in field notes
(check original)

7. Photo Identification
Photo No. _____
Ident. By: _____

8. Plane Coordinate Position Data
State _____ Zone _____
X _____
Y _____
Estab. By _____
Field Book No. _____
Where Filed _____

9. Evaluation
Authentic _____
Needs Verif. Monument No
Re-estab. _____ Survey _____
Land Status _____

5. Investigation Notes: Found 8"x6"x8" stone 5" above ground in good good condition marked X on top, 6 notches on N face, 6 notches on S face, 4 on E face and 2 on W face. Placed by corner post that is used on fence line running E & W then N. From sub point I went East 150' along fence line, running E & W, to intersection of north fence line. There is a silver tag on fence post that is used as corner post. The stone is 14" from base of stone Post.
I sprayed silver paint on stone and put' do not distrub sign on post. The area has been logged. No B.Ts. found. Two fir stumps remaining, these may be B.Ts. One at N 3° W is up-rooted. The other is N 60° E from Cor.
Follow logging road till you come to fir stump w/k tag on r/side of road. On l/side of road is 13" fir w/k tag. This is sub. pt. tree.
(see remarks on reverse)

6. Signed A. Galbraith Title Range Tech Date 5-13-64

gl

7

PERPETUATION RECORD

10. Monument:

11. Accessories

Field Book _____ Page _____

12. Set By _____ Title _____

13. Recorded By _____ Volume _____ Page _____

(Agency)

License _____ Agency _____ Date _____

(Date) (City) (County) (State)

14. Remarks:

K tag on sub. pt. reads see Cor T3N, R37E, 150' East, NRI 8-18-60

Silver tag on post reads $\frac{36}{514}$

H.P. Cor

LDB

9-5-57

A-9

USDA-FOREST SERVICE

Index

File No. 2-9

CORNER RECORD (SEARCH)

(Ref. FSM 7151.4)

Tract or Survey No. C

Cor. No. 2-9

T 4N R. 37E

R.D. _____ County _____

Merid. _____

N.F. _____ State _____

CORNER DIAGRAM

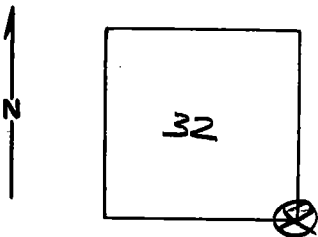

DESCRIBE CORNER MONUMENT FOUND

County Record = Line #27, Drawing # I 153,
found stone w/ " + " , USFS, streamer - 1974.
See R6-7100-57 for additional.

DESCRIBE ~~BEARING TREES~~ OR OTHER OFFICIAL ACCESSORIES FOUND

(Stake TAG in fence, 1 Ch. East of Road)
(stone w/ scribed X on top)

PHOTO IDENTIFICATION DATA

Photo No. _____

Filed At. _____

Object Ident. _____

Ident. By _____

Signature _____

PLANE COORDINATE POSITION DATA

State _____ Zone _____

X _____

Y _____

Estab. By _____

Agency _____

Signature

TGH

Title

Division

Headquarters

Date

2-5-79

7100-52-(3/68)

CORNER RECORD (PERPETUATION)

MONUMENT : DESCRIBE NEW MONUMENT SET, OR WORK DONE TO PRESERVE EXISTING MONUMENT

9

ACCESSORIES : DESCRIBE NEW BT'S WITNESS OBJECTS ETC. ESTABLISHED, OR WORK DONE TO PRESERVE EXISTING EVIDENCE

10

Work Done By _____ Title _____ Date _____ State Registration No. or Agency _____

Certified Cor. Record Prepared ? Yes No Filed At: _____ Date _____ 11

REMARKS

12

Index File No. T. R. M. Tract or Surv. No. Cor. U.S. G.P.O. 1977-725-576/586 13