

USDA-FOREST SERVICE

Index
File No. F.80-03
T 4N R. 30E
Merid. Willamette

CORNER RECORD (SEARCH)

(Ref. FSM 7151.4)

Walla Walla County
N.F. Umatilla State Oregon
Tract or Survey No. 061411 Cor. No. 3

CORNER DIAGRAM

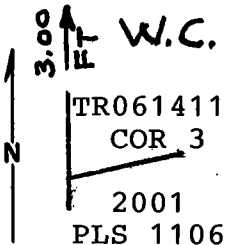

DESCRIBE CORNER MONUMENT FOUND

None. This corner was established and monumented as part of this survey.

DESCRIBE BEARING TREES OR OTHER OFFICIAL ACCESSORIES FOUND

None.

PHOTO IDENTIFICATION DATA

Photo No. _____
Filed At. _____
Object Ident. _____
Ident. By _____
Signature

DESCRIBE CORNER LOCATION RELATIVE TO NEAR-BY FEATURES, ALSO HOW TO REACH CORNER

Witness corner is located on flat ground, on the North-South centerline of Section 7, about 40 feet North of the Walla Walla River Trail and 75 feet North of the Walla Walla River.

PLANE COORDINATE POSITION DATA

State _____ Zone _____
X _____
Y _____
Estab. By _____
Agency

Signature William R. Wells Title PLS Division _____ Headquarters Pendleton, OR Date 9-26-01 FS-7100-52 (3/68)

CORNER RECORD (PERPETUATION)

MONUMENT: DESCRIBE NEW MONUMENT SET, OR WORK DONE TO PRESERVE EXISTING MONUMENT

Corner falls in 30" dia. white fir (in poor condition), therefore set a witness corner S 01°00'21" W, 3.00' from corner point, a 2 1/2" x 30" aluminum pipe with a 2 1/2" aluminum cap 24" in the ground, surrounded with a mound of earth and stone. Set steel fence post South of corner and attached signs 54-2 and 54-4.

9

ACCESSORIES : DESCRIBE NEW BT'S WITNESS OBJECTS ETC. ESTABLISHED, OR WORK DONE TO PRESERVE EXISTING EVIDENCE

A 21" ponderosa pine bears S72 1/2°E, 40.1', scribed "X" at breast height and "BT" at base. A 6" white fir bears S13 1/2°W, 17.7', scribed "X" at breast height and "BT" at base. Bearing trees have a brass washer stamped "PLS 1106" nailed to face of blaze, painted blaze faces only, on bearing trees. Did not place signs on bearing trees.

10

Work Done By	W.R. Wells	Title	PLS	Date	State Registration No. or Agency	PLS 1106
Certified Cor. Record Prepared ?	Yes <input checked="" type="checkbox"/>	No <input type="checkbox"/>	Filed At:	Um. Co. Sur. Off.	Date	09/01

11

REMARKS

Witnessed by:
Jason Wells, LSIT
Mark Hammersla

12

Index File No.	T.	R.	M.	Tract or Surv. No.	061411	Cor.	3
		4N	38E	Willamette			

13