

USDA-FOREST SERVICE

Index

File No. U-7

CORNER RECORD (SEARCH)

(Ref. FSM 7151.4)

Tract or

Survey No.

Cor.

No.

T 4N R. 38E

R.D. WW County UMATILLA

Merid. W

N.F. UMATILLA State OREGON

CORNER DIAGRAM

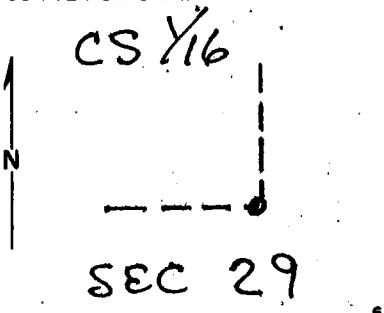

DESCRIBE CORNER MONUMENT FOUND

NONE SET BY GLO

DESCRIBE BEARING TREES OR OTHER OFFICIAL ACCESSORIES FOUND

NONE SET BY GLO

PHOTO IDENTIFICATION DATA

Photo No. _____

Filed At. _____

Object Ident. _____

Ident. By _____

Signature

PLANE COORDINATE POSITION DATA

State _____ Zone _____

X _____

Y _____

Estab. By _____

Agency

DESCRIBE CORNER LOCATION RELATIVE TO NEAR-BY FEATURES, ALSO HOW TO REACH CORNER

DRIVE ON 030 SPUR OFF 6401 RD TO SPUR JUNCTION - GO NORTH ON SPUR TO LANDING. HIKE SW APPROX 300 FT TO CORNER.

Edwin A. Stuyker

Signature

PHS

Title

Division

Headquarters

Date

8/4/69

FS-7100-52 (3/68)

CORNER RECORD (PERPETUATION)

MONUMENT: DESCRIBE NEW MONUMENT SET, OR WORK DONE TO PRESERVE EXISTING MONUMENT

SET 2 1/2" DIA X 30" ALUM MON
26" IN THE GROUND. NO STONES
available. Cap marked!

TAN R38E WM

CS Y16

C

S29 E

1989

STRYKER PHS 2060

ACCESSORIES: DESCRIBE NEW BT'S WITNESS OBJECTS ETC. ESTABLISHED, OR WORK DONE TO PRESERVE EXISTING EVIDENCE

BT 8" True fir bears S74W at 20.6 ft.
scribed "CS Y16 S29 BT"

BT 7" True fir bears S13E at 19.4 ft.
scribed "CS Y16 S29 BT"

Placed brass washer "PHS 2060" at base of both blazes 10

Work Done By E.A. Stryker Title OPHS Date 8/4/89 State Registration No. 2060
or Agency

Certified Cor. Record Prepared? Yes No Filed At: Umatilla Cty Date AUG 89 11

REMARKS

Painted red Bands around both BT's
Placed 54-3 signs and 54-4 signs on both BT's
Placed 54-9 sign and 54-2 sign on steel post set
5 ft north of corner.

Index File No.

U-7

T.

AN

R.

38E

M.

W

Tract or Surv. No.

Cor.