

USDA-FOREST SERVICE

Index

File No. W-14

CORNER RECORD (SEARCH)

(Ref. FSM 7151.4)

Tract or

Survey No. _____

Cor.

No. 116

T 4N R. 3BE

R.D. Walla Walla County Umatilla

Merid. Will

N.F. Umatilla State OR

CORNER DIAGRAM

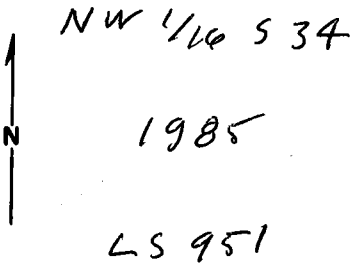

DESCRIBE CORNER MONUMENT FOUND

NONE

DESCRIBE BEARING TREES OR OTHER OFFICIAL ACCESSORIES FOUND

NONE

PHOTO IDENTIFICATION DATA

Photo No. _____

Filed At. _____

Object Ident. _____

Ident. By _____

Signature

PLANE COORDINATE POSITION DATA

State _____ Zone _____

X _____

Y _____

Estab. By _____

Agency

DESCRIBE CORNER LOCATION RELATIVE TO NEAR-BY FEATURES, ALSO HOW TO REACH CORNER

From Jct Rd. #6A01 with #64
 Go East on #64 1.3 mile to pvt drive
 to North.
 Corner is North 400' ± from Rd. #64

Signature
G.D. Edward

Title
LS 951

Division

Headquarters
Hermiston

Date
7/19/85

7100-52 (3. 68)

CORNER RECORD (PERPETUATION)

MONUMENT: DESCRIBE NEW MONUMENT SET, OR WORK DONE TO PRESERVE EXISTING MONUMENT

set 2" x 30" Iron pipe 24" in ground- with Brass Cap stamped as diagram

Drove steel fence post 3 ft East & attached 54-9 sign

ACCESSORIES: DESCRIBE NEW BT'S WITNESS OBJECTS ETC. ESTABLISHED, OR WORK DONE TO PRESERVE EXISTING EVIDENCE

a 6" fir bears N 40° E 7.7 ft. scribed NW 1/16 S 34 BT

a 5" fir bears S 43 1/2° E 9.6 ft. scribed NW 1/16 S 34 BT

a 7" fir bears S 74° W 19.6 ft. scribed NW 1/16 S 34 BT

I nailed alum. tags stamped 951 to Btm Blazes & painted Blazes Red.

Painted red band around BT's and nailed USFS 54-3 & 54-9 ^{signs} _{etc.}

Work Done By G.D. Edwards Title LS Date 7/11/85 State Registration No. OR 951
or Agency

Certified Cor. Record Prepared? Yes No Filed At: Pendleton, OR Date 7 1985

REMARKS