

USDA-FOREST SERVICE

Index

File No. X-5

CORNER RECORD (SEARCH)

(Ref. FSM 7151.4)

Tract or

Survey No. _____

Cor.

No. X-5

T. 4N R. 38E

R.D. WALLA WALLA County UMATILLA

Merid. Willamette

N.F. UMATILLA State OREGON

CORNER DIAGRAM

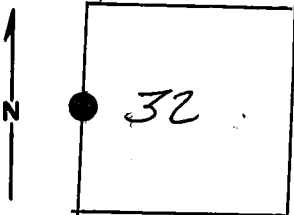

DESCRIBE CORNER MONUMENT FOUND

FND 2 1/2" BRASS CAP ON 1" PIPE SET BY
GLO IN 1939

DESCRIBE BEARING TREES OR OTHER OFFICIAL ACCESSORIES FOUND

11" FIR, DEAD & DOWN N 71 W 8 LKS. Scribes visible
(MY BEARING WAS N65W)

12" FIR 563 E 6 LKS - scribes visible.
DEAD & DOWN. (MY BEARING WAS S73E)

PHOTO IDENTIFICATION DATA

Photo No. _____

Filed At. _____

Object Ident. _____

Ident. By _____

Signature

PLANE COORDINATE POSITION DATA

State _____ Zone _____

X _____

Y _____

Estab. By _____

Agency

DESCRIBE CORNER LOCATION RELATIVE TO NEAR-BY FEATURES, ALSO HOW TO REACH CORNER

From the Jct. of Hwy 204 & Road 3719, drive Southwly
Along 3719 About .3 mile TO A SKID ROAD ON THE
LEFT. 90 UP SKID ROAD TO TOP OF HILL TURN LEFT
ON SPUT ROAD. 90 NORTHERLY ALONG SPUT ROAD
ABOUT 700 FEET TO CORNER.

Signature

Gregory T. Blackman

Title

Surveyor

Division

Headquarters

Date

7-85

7100-52-(3-68)

CORNER RECORD (PERPETUATION)

MONUMENT: DESCRIBE NEW MONUMENT SET, OR WORK DONE TO PRESERVE EXISTING MONUMENT

SET FENCE POST 52 NORTH WITH ATTN. SIGN.

ACCESSORIES : DESCRIBE NEW BT'S WITNESS OBJECTS ETC. ESTABLISHED, OR WORK DONE TO PRESERVE EXISTING EVIDENCE

PLACED ATTN, & BT. SIGNS ON DOWN B.T'S. PAINTED OLD BT'S. NEW BT'S:

A 24" FIR BEARS N 14 E 58⁸ FT MARKED 1/4 S 32 BT.

A 16" ALPINE FIR BEARS N 52 W 105⁰ FT MKD 1/4 S 31 BT.

Work Done By. Greg BLACKMAN Title SURVEYOR Date 7-85 State Registration No. OPLS 991 or Agency

Certified Cor. Record Prepared? (Yes) No Filed At: UMATILLA COUNTY SURVEYOR Date 7-85

REMARKS

Index File No.

T. 4N R. 38E M. WILLAMETTE Tract or Surv. No.

Cor. 1/4