

CERTIFIED RECORD OF LAND CORNER MONUMENTATION

History of original corner establishment:

Corner established by Ronald L. Munns 11-1-83, documented by survey filed with Umatilla County Surveyor. Survey was done for York and Key. Survey Record states:

Set a 1 1/4" pipe
From which:

- A 10" Spruce bears N 8 E, 5.84 feet to a nail in a blaze.
- A 15" Spruce bears N 73 W, 22.46 feet to a nail in a blaze.

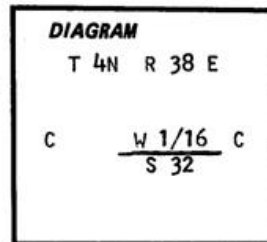

No record of subsequent remonumentation was found in County Records. Description of corner evidence found:

Found a 1 1/4" galvanized pipe.

Found:

A 10" Spruce N 12 E, (record N 8 E) 5.84 feet, distances to double headed form nail set in blaze.

An 18" spruce bears N 73 W, 22.46 feet, distances taken to a doubleheaded form nail set in blaze.

Description of monument and accessories established to perpetuate the original location of this corner:

I placed a 2 1/2"x30" aluminum pipe with aluminum cap, marked as shown over the 1 1/4" pipe, buried the new monument 26" in the ground.

From which:

- A 12" Spruce bears S 82 E, 48.5 feet, marked X Bt, on a single blaze.
- A 23" Spruce bears S 31 E, 37.9 feet, marked CW 1/16 S 32 BT, on a single blaze.

I set steel fence posts 5 feet East with 54-2 and 54-9 signs attached. I also set a steel fence post 5 feet south with a 54-2 sign.

Corner set July 9, 1985

Witness Rick Robinson, Stratton French, Ray Crapo.

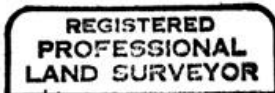
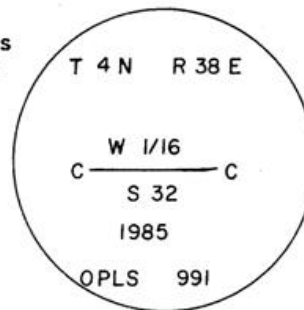

Handwritten signature: Gregory T. Blackman

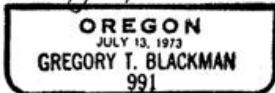

Brass washer marked OPLS 991 nailed to BT blaze. Used steel tape and magnetic compass with 20° declination. Measured to center of tree.

Office of..... County of..... State of..... I hereby certify that the within instrument was filed in this office for record on the..... day of....., 19..... by..... (COUNTY OFFICIAL) (DEPUTY)

Form R6-7100-57 (9/71)

RECEIVED BY

Umatilla County Surveyor Date 7-24-85 Rec'd By [Signature] No. 85-88-R (81-B)