

Index  
 File No. L-17  
 T 4 S. R. 30 E. R.D. Ukiah  
 Merid. Willamette

**CORNER RECORD (SEARCH)**  
 (Ref. FSM 7151.4)  
 County Umatilla  
 N.F. Umatilla State Oregon

Tract or  
 Survey No. \_\_\_\_\_  
 Cor.  
 No. \_\_\_\_\_

**CORNER DIAGRAM**

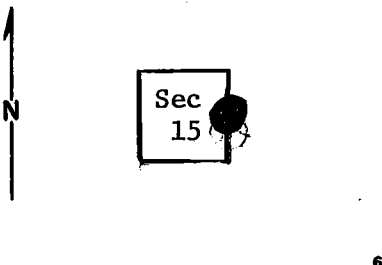

**DESCRIBE CORNER MONUMENT FOUND**  
 Basalt stone, 12" x 10" x 8", 8" above ground, good condition.  
 Markings: ¼ on N. face (appears to have been disturbed. ¼ should be on west face) Sets in stone mound.  
*Monumented By BLM, 1978*

**PHOTO IDENTIFICATION DATA**  
 Photo No. \_\_\_\_\_  
 Filed At. \_\_\_\_\_  
 Object Ident. \_\_\_\_\_  
 Ident. By \_\_\_\_\_  
*Signature*

**DESCRIBE BEARING TREES OR OTHER OFFICIAL ACCESSORIES FOUND**  
 A 20" p.pine bears N.88°E, approx. 50', scribing visible. It has old location poster and old "Attention" poster.  
 A 32" p.pine bears S.10°W., approx. 60'. It has an X chopped in the bark. Scribing visible. (GLO Notes say 40" pine, S.10°W, 73 links) There is an old location poster on a 12" p. pine on north side of a primitive road approx. 6 chains south.

**PLANE COORDINATE POSITION DATA**  
 State \_\_\_\_\_ Zone \_\_\_\_\_  
 X \_\_\_\_\_  
 Y \_\_\_\_\_  
 Estab. By \_\_\_\_\_  
*Agency*

**DESCRIBE CORNER LOCATION RELATIVE TO NEAR-BY FEATURES, ALSO HOW TO REACH CORNER**  
 ¼ corner sets about 15 ft. north of a primitive road in small opening. Road courses approx. NW by SE and runs between the B.T.'s.

Signature	Title	Division	Headquarters	Date	7100-52-(3/68)
T, Hollamon	Eng. Tech,		S.O.	5/31/74	

**CORNER RECORD (PERPETUATION)**

**MONUMENT: DESCRIBE NEW MONUMENT SET, OR WORK DONE TO PRESERVE EXISTING MONUMENT**

**ACCESSORIES : DESCRIBE NEW BT'S WITNESS OBJECTS ETC. ESTABLISHED, OR WORK DONE TO PRESERVE EXISTING EVIDENCE**

I placed blank B.T. tags on the two B.T.'s.

**Work Done By** \_\_\_\_\_ **Title** \_\_\_\_\_ **Date** \_\_\_\_\_ **State Registration No.**  
**or Agency** \_\_\_\_\_

**Certified Cor. Record Prepared ?** Yes  No  **Filed At:** \_\_\_\_\_ **Date** \_\_\_\_\_

**REMARKS**

**Index File No.** \_\_\_\_\_ **T.** \_\_\_\_\_ **R.** \_\_\_\_\_ **M.** \_\_\_\_\_ **Tract or Surv. No.** \_\_\_\_\_ **Cor.** \_\_\_\_\_