

Index

File No. J-9

CORNER RECORD (SEARCH)

(Ref. FSM 7151.4)

Tract or

Survey No. _____

Cor.

No. _____

T 4 S _____ R. 31 E.R.D. UkiahCounty Umatilla

Merid. WillametteN.F. UmatillaState Oregon

CORNER DIAGRAM

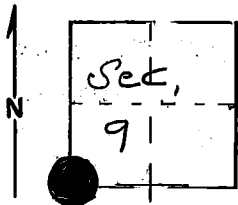

DESCRIBE CORNER MONUMENT FOUND

Material: Basalt Stone Size: 18" X 12" X 4"

Height Above Ground: 1 foot Condition: Good

Markings: Sets on edge in stone mound. Approximatley fits GLO notes. No visiblr marks.

Monumented By BLM 1978

DESCRIBE BEARING TREES OR OTHER OFFICIAL ACCESSORIES FOUND

A double boled ponderosa pine bears S 40° W, 33 feet. Each bole about 36" DBH. Has scar where blaze may have been. Fits GLO. A very rotten fir stump bears N 41° E, approximately 40 feet fits GLO. --A very rotten fir stump bears N 36° W. Approximately 35 feet scribing on loose sliver 8 feet East of stump.

PHOTO IDENTIFICATION DATA

Photo No. _____

Filed At. _____

Object Ident. _____

Ident. By _____

Signature

PLANE COORDINATE POSITION DATA

State _____ Zone _____

X _____

Y _____

Estab. By _____

Agency

Signature

T, Hollamon

Title

Eng, Tech,

Division

Headquarters

Date

4-27-76

7100-52 (3/68)

5

CORNER RECORD (PERPETUATION)

 MONUMENT: DESCRIBE NEW MONUMENT SET, OR WORK DONE TO PRESERVE EXISTING MONUMENT

9

 ACCESSORIES : DESCRIBE NEW BT'S WITNESS OBJECTS ETC. ESTABLISHED, OR WORK DONE TO PRESERVE EXISTING EVIDENCE

Placed blank B.T. tags on the pine SW, remnants of fir stump NE, and on scribed sliver NW.

Placed location poster on 16" ponderosa pine approximatley 200 feet S 40 E from corner.
Poster is about 100 feet North of Primitive Road and visible from it.

10

 Work Done By _____ Title _____ Date _____ State Registration No. or Agency _____

 Certified Cor. Record Prepared ? Yes No Filed At: _____ Date _____ 11

REMARKS

12

 Index File No. T. R. M. Tract or Surv. No. Cor. 13
