

Index
File No. P-25

CORNER RECORD (SEARCH)

(Ref. FSM 7151.4)

Tract or
Survey No. _____ No. _____

T 4S R. 30E-31E R.D. Ukiah County Umatilla

Merid. Willamette N.F. UMATILLA State Oregon

CORNER DIAGRAM

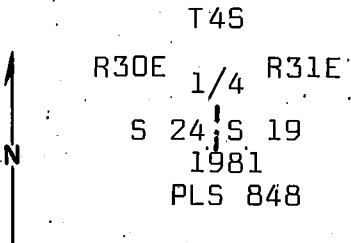

DESCRIBE CORNER MONUMENT FOUND

Found depression in the ground which appears to be where a tree once grew.

DESCRIBE BEARING TREES OR OTHER OFFICIAL ACCESSORIES FOUND

Found down, dead, rotten pine tree at approx. record call position from depression. Proportion position falls in depression; therefore, accepted as 1/4 corner position.

PHOTO IDENTIFICATION DATA

Photo No. _____

Filed At: _____

Object Ident. _____

Ident. By _____

Signature

PLANE COORDINATE POSITION DATA

State _____ Zone _____

X _____

Y _____

Estab. By _____

Agency

Signature

Title

Division

Headquarters

Date

7100-52-(3/68)

PLS 848

Mt. Vernon, OR

8/13/81

CORNER RECORD (PERPETUATION)

MONUMENT: DESCRIBE NEW MONUMENT SET, OR WORK DONE TO PRESERVE EXISTING MONUMENT

Set 3"x30" galv. iron pipe with 3" brass cap stamped as shown on the diagram, set 26 inches in the ground.

From which:

ACCESSORIES : DESCRIBE NEW BT's WITNESS OBJECTS ETC. ESTABLISHED, OR WORK DONE TO PRESERVE EXISTING EVIDENCE

A fir 11 in. dia. bears N25°E, 12.3 ft. scribed 1/4 S 19 BT.

A pine 12 in. dia. bears S67°W, 5.7 ft. scribed 1/4 S 24 BT.

Set steel posts with warning and boundary signs 5 ft. South and 5 ft. West from corner.

Nailed bearing tree signs and brass washers stamped PLS 848 to each tree. Painted a red band around each tree.

Work Done By D.M. Ferguson Title Surveyor Date 8/13/81 State Registration No. OR PLS 848
or Agency

Certified Cor Record Prepared? Yes No Filed At: Umatilla Co. Surveyor Off Date

REGISTERED
PROFESSIONAL
LAND SURVEYOR

REMARKS

Witnesses to above corner:

D. Mitchell Ferguson
Mike Woodward

OREGON
JULY 12, 1968
DOUGLAS M. FERGUSON

Index File No. 848

T.

R.

M.

Tract or Surv. No.

Cor.

Index
File No. P-25
T 4 S. R. 30 E.
Merid. Willamette

CORNER RECORD (SEARCH)
(Ref. FSM 7151.4)

Tract or
Survey No. _____
Cor.
No. _____
R.D. Ukiah County Umatilla
N.F. Umatilla State Oregon

CORNER DIAGRAM

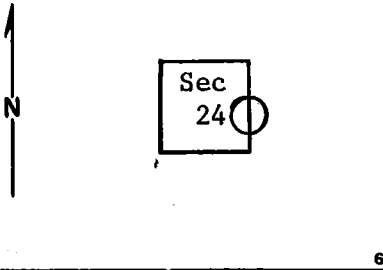

DESCRIBE CORNER MONUMENT FOUND

None
Could find nothing.

DESCRIBE BEARING TREES OR OTHER OFFICIAL ACCESSORIES FOUND

One of the original B.T.'s was listed as 40" diam.
There are no trees this large in the area.

PHOTO IDENTIFICATION DATA

Photo No. _____
Filed At. _____
Object Ident. _____
Ident. By _____
Signature

DESCRIBE CORNER LOCATION RELATIVE TO NEAR-BY FEATURES, ALSO HOW TO REACH CORNER

PLANE COORDINATE POSITION DATA

State _____ Zone _____
X _____
Y _____
Estab. By _____
Agency

Signature
T, Hollamon

Title
Eng, Tech.

Division

Headquarters
S, O,

Date
5/17/74

7100-52-(3/68)

6

7

8

2

3

4

5

CORNER RECORD (PERPETUATION)

MONUMENT: DESCRIBE NEW MONUMENT SET, OR WORK DONE TO PRESERVE EXISTING MONUMENT

ACCESSORIES : DESCRIBE NEW BT'S WITNESS OBJECTS ETC. ESTABLISHED, OR WORK DONE TO PRESERVE EXISTING EVIDENCE

Work Done By. _____ Title _____ Date _____ State Registration No. _____
or Agency _____

Certified Cor. Record Prepared ? Yes No Filed At: _____ Date _____

REMARKS