

Index
File No. 5-25
T 45 R. 30 & 31E
Merid. Willamette

CORNER RECORD (SEARCH)
(Ref. FSM 7151.4)

R.D. Ukiah County Umatilla Tract or Survey No. _____ Cor. No. _____
N.F. Umatilla State Oregon

CORNER DIAGRAM

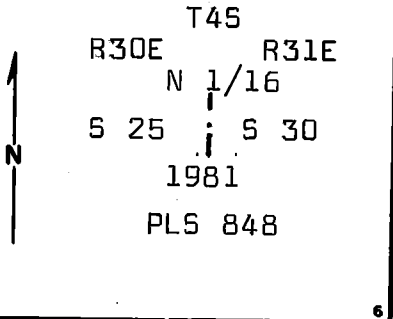

DESCRIBE CORNER MONUMENT FOUND
Corner not previously established.

DESCRIBE BEARING TREES OR OTHER OFFICIAL ACCESSORIES FOUND
N/A

PHOTO IDENTIFICATION DATA
Photo No. _____
Filed At. _____
Object Ident. _____
Ident. By _____
Signature

DESCRIBE CORNER LOCATION RELATIVE TO NEAR-BY FEATURES, ALSO HOW TO REACH CORNER
Corner is on gentle North slope in open timber. Ridge road, coursing SE approx. 1000 ft. South from corner.

PLANE COORDINATE POSITION DATA
State _____ Zone _____
X _____
Y _____
Estab. By _____
Agency

Signature

Title _____ Division _____ Headquarters _____ Date _____
PLS 848 Mt. Vernon, OR 7/28/81

CORNER RECORD (PERPETUATION)

MONUMENT: DESCRIBE NEW MONUMENT SET, OR WORK DONE TO PRESERVE EXISTING MONUMENT

Set 3"x30" galv. iron pipe with 3" brass cap stamped as shown on the diagram. Set pipe 16 inches in the ground and raised a mound of stone around the pipe.

From which:

ACCESSORIES : DESCRIBE NEW BT'S WITNESS OBJECTS ETC. ESTABLISHED, OR WORK DONE TO PRESERVE EXISTING EVIDENCE

A pine 16 inches dia. bears N39°E, 7.7 ft. scribed N 1/16 S 30 BT.
A pine 16 inches dia. bears S64°W, 8.5 ft. scribed N 1/16 S 25 BT.
Set steel posts with warning and bounday signs 6 ft. West and 5 ft. South from corner.
Nailed brass washers stamped PLS 848 and bearing tree signs to each tree.
Painted red band around each tree.

Work Done By D.M. Ferguson Title Surveyor Date 7/28/81 State Registration No. or Agency OR PLS 848

Certified ~~RECORDED~~ ~~Deposited~~? Yes No Filed At: Umatilla Co. Surveyor Off. Date

**PROFESSIONAL
LAND SURVEYOR**

REMARKS

Witnesses to above corner:
D. Mitchell Ferguson
Mike Woodward

**OREGON
JULY 12, 1968
DOUGLAS M. FERGUSON
848**