

USDA-FOREST SERVICE

Index
File No. N-25

CORNER RECORD (SEARCH)

(Ref. FSM 7151.4)

Tract or
Survey No. _____ Cor. No. N-25

T 45 R. 32 E

R.D. Uria County Umatilla

Merid. Will

N.F. Umatilla State Oregon

CORNER DIAGRAM

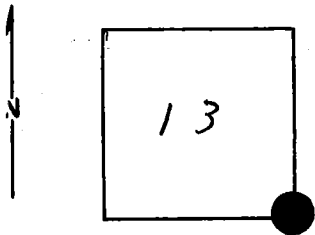

DESCRIBE CORNER MONUMENT ~~FOUND~~ SET

Brass Cap! 1977

DESCRIBE BEARING TREES OR OTHER OFFICIAL ACCESSORIES FOUND

Notes on file! See Monumentation File

PHOTO IDENTIFICATION DATA

Photo No. _____

Filed At. _____

Object Ident. _____

Ident. By _____

Signature

PLANE COORDINATE POSITION DATA

State _____ Zone _____

X _____

Y _____

Estab. By _____

Agency

Signature

Title

Division

Headquarters

Date

7100-52-(3/68)

CORNER RECORD (PERPETUATION)

GPO 902-678

MONUMENT : DESCRIBE NEW MONUMENT SET, OR WORK DONE TO PRESERVE EXISTING MONUMENT

9

ACCESSORIES : DESCRIBE NEW BT's WITNESS OBJECTS ETC. ESTABLISHED, OR WORK DONE TO PRESERVE EXISTING EVIDENCE

10

Work Done By _____ Title _____ Date _____ State Registration No. or Agency _____

Certified Cor. Record Prepared? Yes No . Filed At: _____ Date _____

11

REMARKS

12

Index File No. T. R. M. Tract or Surv. No. Cor.

13

Index

File No. N-1

CORNER RECORD (SEARCH)

(Ref. FSM 7151.4)

Tract or

Survey No. 5-82

Cor.

No. N-1

T 4S R. 33E

R.D. Ukiah

County

Umatilla

Merid. Willamette

N.F. Umatilla

State

Oregon

CORNER DIAGRAM

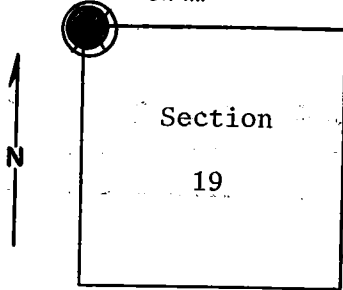

DESCRIBE CORNER MONUMENT FOUND

~~Sec N 25, T4S, R32E.~~

Brass Cap; see Monument File

DESCRIBE BEARING TREES OR OTHER OFFICIAL ACCESSORIES FOUND

PHOTO IDENTIFICATION DATA

Photo No. _____

Filed At. _____

Object Ident. _____

Ident. By _____

Signature

6

DESCRIBE CORNER LOCATION RELATIVE TO NEAR-BY FEATURES, ALSO HOW TO REACH CORNER

PLANE COORDINATE POSITION DATA

State _____ Zone _____

X _____

Y _____

Estab. By _____

Agency

8

Signature

Title

Division

Headquarters

Date

T, Hollamon

Engineering Technician

S.O.

December 5, 1975

7100-52-(3/68)

4

5

CORNER RECORD (PERPETUATION)

MONUMENT: DESCRIBE NEW MONUMENT SET, OR WORK DONE TO PRESERVE EXISTING MONUMENT

ACCESSORIES : DESCRIBE NEW BT'S WITNESS OBJECTS ETC. ESTABLISHED, OR WORK DONE TO PRESERVE EXISTING EVIDENCE

Work Done By _____ Title _____ Date _____ State Registration No. _____
or Agency _____

Certified Cor. Record Prepared ? Yes No Filed At: _____ Date _____

REMARKS

Index File No. T. R. M. Tract or Surv. No. Cor.