

Index

File No.

R-3

CORNER RECORD (SEARCH)

(Ref. FSM 7151.4)

Tract or

Survey No.

Cor.

No.

T 4S R. 34E

R.D. LaGrande

County Union

Merid. Willamette

N.F. W-W

State Oregon

CORNER DIAGRAM

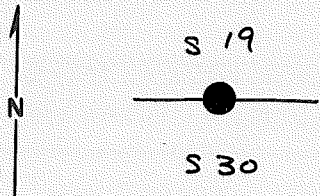

DESCRIBE CORNER MONUMENT FOUND

Original basalt stone, 18x12x5" loosely set in mound of stone, mtd 1/4 on W. face.

DESCRIBE BEARING TREES OR OTHER OFFICIAL ACCESSORIES FOUND

Ponderosa pine, 35" dia, brs N25E, 226 lbs dist w/ heated blaze.

Ponderosa pine, 25" dia; brs S70E, 84 lbs, w/ scribe marks 1/4S visible on open blaze.

PHOTO IDENTIFICATION DATA

Photo No. _____

Filed At. _____

Object Ident. _____

Ident. By _____

Signature

PLANE COORDINATE POSITION DATA

State _____ Zone _____

X _____

Y _____

Estab. By _____

Agency

Signature

Title

Division

Headquarters

Date

CORNER RECORD (PERPETUATION)

MONUMENT: DESCRIBE NEW MONUMENT SET, OR WORK DONE TO PRESERVE EXISTING MONUMENT

Brass Cap mkd: T4 S R 34 E
1/4 519
530
1977

ACCESSORIES: DESCRIBE NEW BT'S WITNESS OBJECTS ETC. ESTABLISHED, OR WORK DONE TO PRESERVE EXISTING EVIDENCE

Deposit corner stone and set a 5ft steel fence post alongside iron post.

Work Done By BCM Title _____ Date 9/77 State Registration No. or Agency _____

Certified Cor. Record Prepared? Yes No Filed At: _____ Date _____

REMARKS

Index
 File No. R-3 CORNER RECORD (SEARCH)
 (Ref. FSM 7151.4) Tract or
 T 4S R. 34 E R.D. LA GRANDE County UNION Survey No. Cor. S. 1/4 COR.
 Merid. WILLAMETTE N.F. WALLOWA-WHITMAN State OREGON No. SEC. 19

CORNER DIAGRAM

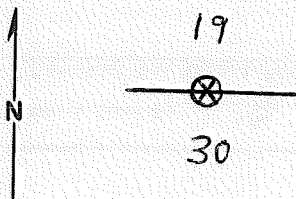

DESCRIBE CORNER MONUMENT FOUND

Rocks, 10x12", are ground level, and in poor condition.

A pile of rocks that have fallen over.
Monumented by BLM '67'

DESCRIBE BEARING TREES OR OTHER OFFICIAL ACCESSORIES FOUND

26" ponderosa pine, alive, approx. 54 feet E. of corner.
 36" ponderosa pine, alive, approx. 149' from 1/4 cor at a N. brs.
 Painted the cor. along with the B.T.'s. A shield was put on
 the 36" p.p. & a location poster on the 26" p.p.

PHOTO IDENTIFICATION DATA

6
 Photo No. UBM 4-3
 Filed At.
 Object Ident.
 Ident. By
Signature 7

PLANE COORDINATE POSITION DATA

8
 State Zone
 X
 Y
 Estab. By
Agency

DESCRIBE CORNER LOCATION RELATIVE TO NEAR-BY FEATURES, ALSO HOW TO REACH CORNER

3
 The corner sets in a large opening approx. 550' E. of S-214.
 A road location poster was put along S-214 on the W-W N.F.
 boundary sign.

Signature
SAK & JMJ

Title

Division

Headquarters

Date

11/9/65

7100-52-(3/68)

5

CORNER RECORD (PERPETUATION)

MONUMENT: DESCRIBE NEW MONUMENT SET, OR WORK DONE TO PRESERVE EXISTING MONUMENT

ACCESSORIES : DESCRIBE NEW BT'S WITNESS OBJECTS ETC. ESTABLISHED, OR WORK DONE TO PRESERVE EXISTING EVIDENCE

Work Done By _____ Title _____ Date _____ State Registration No. _____
or Agency _____

Certified Cor. Record Prepared ? Yes No Filed At: _____ Date _____

REMARKS

Index-File No. T. R. M. Tract or Surv. No. Cor.

USDA-FOREST SERVICE

Index File No. R-3
T 45 R. 34E
Merid. Will.

CORNER RECORD (SEARCH)

(Ref. FSM 7151.4)

Tract or Survey No. _____
Cor. No. R-3

R.D. Ukiah County Umatilla
N.F. Umatilla State Oregon

CORNER DIAGRAM

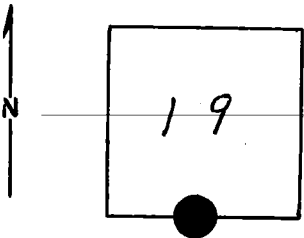

DESCRIBE CORNER MONUMENT ~~FOUND~~ SET

Brass Cap! 1977

DESCRIBE BEARING TREES OR OTHER OFFICIAL ACCESSORIES FOUND

Notes on file! See Monumentation File.

PHOTO IDENTIFICATION DATA

Photo No. _____
Filed At. _____
Object Ident. _____
Ident. By _____
Signature

DESCRIBE CORNER LOCATION RELATIVE TO NEAR-BY FEATURES, ALSO HOW TO REACH CORNER

PLANE COORDINATE POSITION DATA

State _____ Zone _____
X _____
Y _____
Estab. By _____
Agency

Signature _____ Title _____ Division _____ Headquarters _____ Date _____

7100-52-(3/68)

CORNER RECORD (PERPETUATION)

MONUMENT: DESCRIBE NEW MONUMENT SET, OR WORK DONE TO PRESERVE EXISTING MONUMENT

9

ACCESSORIES : DESCRIBE NEW BT'S WITNESS OBJECTS ETC. ESTABLISHED, OR WORK DONE TO PRESERVE EXISTING EVIDENCE

10

Work Done By _____ Title _____ Date _____ State Registration No. or Agency _____

Certified Cor. Record Prepared ? Yes No Filed At: _____ Date _____

11

REMARKS

12

Index File No. T. R. M. Tract or Surv. No. Cor. _____

13