

OREGON CORNER RESTORATION FORM

SECTION 19 TOWNSHIP 5N RANGE 28 R-1

COUNTY: UMATILLA DATE 1/90

CORNER DESIGNATION

SW Corner

CONDITION REPORT ONLY
NOT FOUND
RENEWED
UNRECORDED
X SURVEYED IN
X REFERENCED OUT

PREVIOUS RENEWALS/SURVEYS, ETC.

Original survey by Davenport in 1861 under Contract #101.

MONUMENTS & ACCESSORIES FOUND: Condition and Source

Found a 1"x30" Iron pipe with a 2 3/8" Brass Cap, set by Krumbein in 1973 (See County Survey #1-16-C). This cap is 0.70 ft. below surface of a gravel rd. and N 89° 49' 24" W 5.06 ft. from my single proportion location.

MONUMENT DETAIL

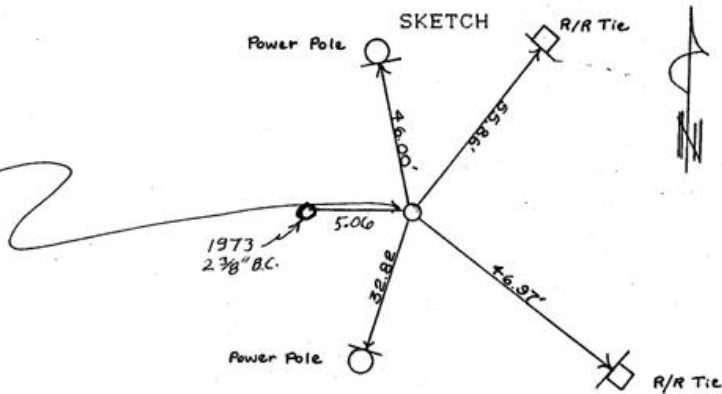
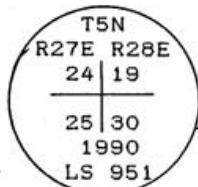

MONUMENT SET (PROCEDURES AND DESCRIPTION)

Set by single proportion a 1"x30" Iron pipe with a 2 3/8" Brass Cap, stamped as shown, 0.35 ft. below the surface of a gravel rd. SEE AREA ONE 1989 UMATILLA CO. SUR.

NEW ACCESSORIES

From which

- Alum. Tag #951 attached to power pole. N 12° 15' 20" W 46.00 feet.
Alum. Tag #951 to R/R tie. N 36° 50' 20" E 55.86 ft
Alum. Tag #951 to " " S 53° 27' 40" E 46.97 ft
Alum. Tag #951 to power pole. S 16° 40' 50" W. 32.82 feet.

Bearing Object signs attached to all accessories.

LOCATION & COMMENTS

On Powerline Rd. & the South city limits of the City of Umatilla go South along Powerline Rd. abt. 1 mile to a gravel rd. to the West; go W along gravel rd. approx. 1.24 mi. to corner.

COMPASS DEC.
FIRM EDWARDS SURVEYING
P.O. BOX 763, HERMISTON, OREGON, 97838
PARTY CHIEF D. EDWARDS
NOTES
WITNESS J. COPPOCK

SURVEYOR'S SEAL

REGISTERED PROFESSIONAL LAND SURVEYOR

G. Dennis Edwards

OREGON JULY 16, 1971 G. DENNIS EDWARDS 951

RECEIVED BY

Umatilla County Surveyor
Date 1-91
Rec'd By KH
No. 91-01-B