

OREGON CORNER RESTORATION FORM

Section: 19
Township: 5 North
Range: 28 East of the Willamette Meridian
Section: 24
Range: 27 East of the Willamette Meridian
County: Umatilla
Date: 3/3/2023

Corner Indexing Information:

Township 5N Range 28E Corner Code P-1 (Willamette Meridian)
Township 5N Range 27E Corner Code P-25 (Willamette Meridian)

Additional Identifier: 1/4 corner common to Sections 19 (T5N R28E) & 24 (T5N R27E)

Oregon Plane Coordinates: N: 816564.36 E: 8489839.16 Zone: North Order: Second
Datum: NAD83-2011(epoch 2010) Convergence: N00°48'05.57"W Scale Factor: 1.00004947633463

Previous Renewals/Surveys, etc.:

1861: Post, mound, pits, & charred stake (Davenport, General Land Office Contract #101)
1991: Established new position on line between 1" iron rod w/5" timber washer at M-1 and 1972 Staebler brass cap at Z-1, set 1-1/2" iron pipe with brass cap. (Edwards, 91-001-B) (PBS notes: we found and accepted an axle at M-1 at a location consistent with Edwards' iron rod & washer; he notes this as an axle on C.S. 82-016-A., we have rejected Staebler's brass cap at Z-1 due to its being set from Gould's 1941 brass cap at T5N R27E Z-23, which has been shown to have been set 1 chain too far West due to an apparent blunder.) Therefore we have rejected this monument.
2006: Found brass cap per C.S. 91-001-B (K. Primm, C.S. 06-461-B)

Monument(s) & Accessories Found (Condition & Source):

Found and rejected Edwards brass cap per C.S. 91-001-B, which bears N83°05'36"W 16.06' from the corner. Also found (2) RM's from 1991 and 2006 surveys, SE and SW of the corner; see "New Accessories" notes below.

Monument Set (Procedures & Description):

Found and accepted Krumbein monument per C.S. S-156-C for Z-1; found and accepted axle per C.S. 91-001-B for M-1. Holding the axle at M-1 and the Krumbein brass cap at Z-1, the position of P-1 was computed at the proportionate distance, resulting in a better fit with an East-West fence running along the South line of Section 18, and also with a projection of the East-West centerline of Section 18 from the monument at L-5 through the center 1/4 (L-3), which is witnessed by a county brass cap monument 50.9' to the South. At single-proportion position between Z-1 and M-1, set a 1-1/4" iron pipe with 2-1/2" brass cap flush with the surface with T-post & sign alongside.

Monument Detail:

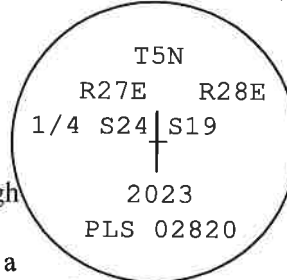

New Accessories: WE SET:

Edwards brass cap stamped "RM 16.06" bears N83°05'36"W 16.06'.
Found 5/8" iron rebar with plastic cap stamped "LS 48490" which bears S69°39'02"W 109.33' from the corner; replaced bearing tag on adjacent fence post;
Set 5/8" iron rebar with plastic cap stamped "WA19619 OR02820" which bears S19°33'52E 140.61' from the corner at base of power pole with existing bearing tag; replaced bearing tag;
Set 5/8" iron rebar with plastic cap stamped "WA19619 OR02820" which bears N08°32'04"E 275.43' from the corner; set bearing tag on adjacent power pole.

Location & Comments:

Corner falls 11' North of a fence running W-SW and +/- 30' West of the center of a farm road.

Compass Declination:

All accessories tied with State Plane grid bearings.

Firm/Agency: PBS Engineering & Environmental, Inc
5 N. Colville
Walla Walla WA 99362

Witness: Jace A. Boland
Bob D. Eisele

Surveyor's Seal

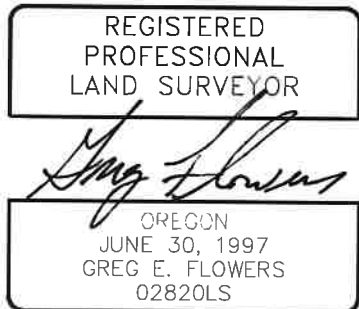

RENEWS 12/31/2025
1/17/2024