

OREGON CORNER RESTORATION FORM

SECTION 19 TOWNSHIP 5N RANGE 28E P-5

COUNTY: UMATILLA DATE 1/90

CORNER DESIGNATION

E 1/4 Corner

- CONDITION REPORT ONLY
- NOT FOUND
- RENEWED
- UNRECORDED
- SURVEYED IN
- REFERENCED OUT

PREVIOUS RENEWALS/SURVEYS, ETC.

Original survey by Davenport in 1861, under Contract #101.

MONUMENTS & ACCESSORIES FOUND: Condition and Source

No evidence found.

MONUMENT DETAIL

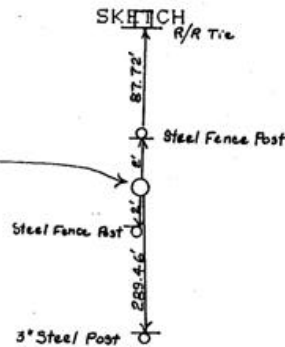
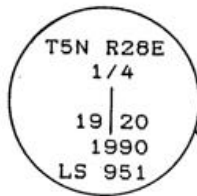

MONUMENT SET (PROCEDURES AND DESCRIPTION)

Set by single proportion a 1"x30" Iron pipe with a 2 3/8" Brass Cap 0.20 ft. above surface of ground and stamped as shown.

NEW ACCESSORIES

- From which
- A steel fence post w/Bearing Object, Witness signs attached. North 2 feet.
- A steel fence " w/ " " " signs "
- South 2 feet.
- A R/R tie w/Alum. Tag #951 & Bearing Object sign N 00° 24' 00 E 87.72 feet. Dist. to Alum. Tag
- A 3" OD Iron pipe 3 ft. high, set in conc. over H2O line w/Bearing Object sign attached. S 01° 25' 30" E. 289.46 feet.

LOCATION & COMMENTS

From City of Umatilla H2O storage tank at the SW Corner of Sec 20, T5N, R28E, go North approx. 2500 feet to corner which is in N-S fenceline.

COMPASS DEC.
 FIRM EDWARDS SURVEYING
 P.O. BOX 763, HERMISTON,
 OREGON, 97838
 PARTY CHIEF D. EDWARDS
NOTES
 WITNESS J. COPPOCK

SURVEYOR'S SEAL

REGISTERED
 PROFESSIONAL
 LAND SURVEYOR

G. Dennis Edwards

OREGON
 JULY 18, 1897
 G. DENNIS EDWARDS
 951

RECEIVED BY

Umatilla County Surveyor

Date 1-91

Rec'd By KA

No. 91-01-B