

OREGON CORNER RESTORATION FORM

Section: 19 – 24 – 25 – 30
Township: 5 North
Range: 28 East of the Willamette Meridian
County: Umatilla
Date: January 2024
Corner Indexing Information: Township 5N Range 28E Corner Code R-17 (Willamette Meridian)
Additional Identifier: Corner common to Sections 22, 23, 26 & 27

Oregon Plane Coordinates: N: 814224.33 E: 8511084.76 **Zone:** North **Order:** Second
Datum: NAD83-2011(epoch 2010) **Convergence:** N00°51'38"W **Scale Factor:** 1.000044268448
Previous Renewals/Surveys, etc.:

1861: Post, mound, pits, & charred stake (Davenport, General Land Office Contract #101)
1909: GLO corner found, not described (J. Kimbrell, C.S. 293)
1911: Corner found, not described (J. Kimbrell, C.S. 330)
1972: NF; computed by double-proportion between brass cap at R-9 and computed position for R-25, and between a brass cap at N-17 and a pipe at V-17 (Krumbein C.S. J-100-A & H-122-B) (PBS note: the computed position for R-25 is based on a monument at Z-25 that is no longer accepted. However, the recomputed position for P-17 based on the accepted position of Z-25 is not significantly different than the position of the found monument, therefore because of its historical use and dependence thereon we have accepted this corner.)
1988: C.S. 88-045-C Edwards Found brass caps & W.C.'s Krumbein & a brass cap witness corner bears S66°52'W 32.53 feet & a brass cap witness corner bears S70°31'E 39.53 feet.

Monument(s) & Accessories Found (Condition & Source):
2-1/2" brass cap 1.1' deep, 4' W & 7' S of the as-built intersection of Bensel Rd and Sagebrush Rd. Also found a 2-1/2" brass cap marked for witness corner, S66°05'05"W 32.55 feet.

Monument Set (Procedures & Description):
N/A

Monument Detail:

New Accessories: WE SET:

A 5/8" iron rebar with plastic cap stamped "WA19619 OR02820" bears S54°53'30"E 26.46 feet from the corner, set bearing tag on adjacent power pole;
A 5/8" iron rebar with plastic cap stamped "WA19619 OR02820" bears S68°25'34"E 50.84 feet from the corner, set bearing tag on adjacent fence post;
A 5/8" iron rebar with plastic cap stamped "WA19619 OR02820" bears N21°09'43"W 46.28 feet from the corner, set bearing tag on adjacent mile post;
A 5/8" iron rebar with plastic cap stamped "WA19619 OR02820" which bears N53°20'21"W 50.15 feet from the corner attached bearing tag to adjacent T-post.

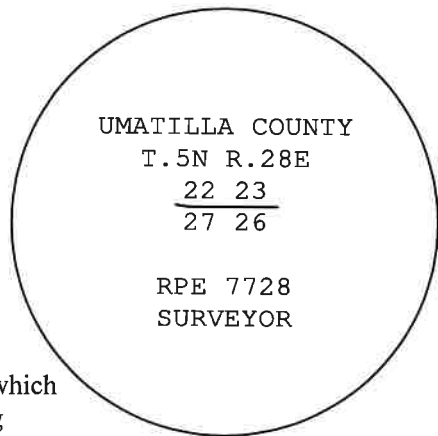

Location & Comments:
Corner falls in the intersection of Bensel Road and Sagebrush Road.

Compass Declination:
All accessories tied with State Plane grid bearings.

Firm/Agency: PBS Engineering & Environmental, Inc
5 N. Colville
Walla Walla WA 99362

Witness: Mark F. Wendover
Jered M. Clifford
A.J. Nickels

Surveyor's Seal

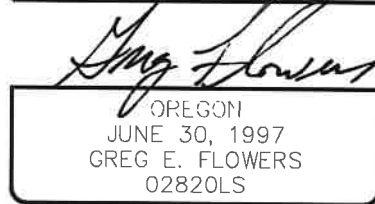

RENEWS 12/31/2025
1/24/2024