

OREGON CORNER RESTORATION FORM

Section: 19 – 20 – 29– 30
Township: 5 North
Range: 28 East of the Willamette Meridian
County: Umatilla
Date: January 2024
Corner Indexing Information: Township 5N Range 28E Corner Code R-5 (Willamette Meridian)
Additional Identifier: Common corner to sections 19, 20, 29 & 30
Oregon Plane Coordinates: N: 814000.97 E: 8495151.30 **Zone:** North **Order:** Second
Datum: NAD83-2011(epoch 2010) **Convergence:** N00°48'58"W **Scale Factor:** 1.000044268448

Previous Renewals/Surveys, etc.:

1861: post, mound, pits, & charred stake (Davenport, General Land Office Contract #101)
1973: Established position by proportionate method, using 1943 GLO brass caps at Z-23 (T5N R27E) and Z-9 to establish Z-1 and Z-5, holding Z-1 and a pipe at M-1 to establish R-1, holding Z-5 and a copper pin at N-5, a brass cap at V-13 and the computed R-1 for proportioning of R-5; set brass cap. (Krumbein, C.S. I-016-C) (PBS note: the GLO brass cap at T5N R27E Z-3 has been shown to be set one chain too far West due to an apparent blunder. We have thus rejected most of the monuments derived from this blunder, however we have accepted this monument at R-5 due to the dependence thereon by multiple subdivisions within Section 20).

Monument(s) & Accessories Found (Condition & Source):

2-1/2" brass cap per C.S. I-016-C, 0.4' below surface; a cut off T-post falls 1.0' South; a cut off angle iron post N30°E 2.3'.

Monument Set (Procedures & Description):

N/A

Monument Detail:

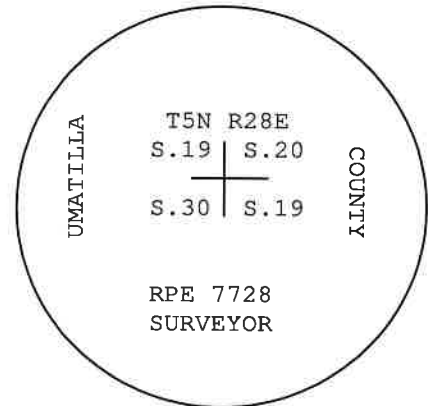

New Accessories: WE SET:

- A 5/8" iron rebar with plastic cap stamped "WA19619 OR02820" which bears N55°57'16"W 65.89' from the corner; set bearing tag on adjacent power pole;
- A 5/8" iron rebar with plastic cap stamped "WA19619 OR02820" which bears S83°19'57"W 301.52' from the corner; set bearing tag on adjacent power pole;
- A 5/8" iron rebar with plastic cap stamped "WA19619 OR02820" which bears N60°46'10"E 93.81' from the corner; set bearing tag on adjacent power pole;
- A 5/8" iron rebar with plastic cap stamped "WA-19619 OR02820" which bears S28°44'48"E 33.43' from the corner; set bearing tag on adjacent power pole.

Location & Comments:

Corner falls 17' South of County Road 1226 and 1.5' West of a N-S running fence on the North side of the road.

Compass Declination:

All accessories tied with State Plane grid bearings.

Firm/Agency: PBS Engineering & Environmental, Inc
5 N. Colville
Walla Walla WA 99362

Witness: Mark F. Wendover
Jered M. Clifford
A.J. Nickels

Surveyor's Seal

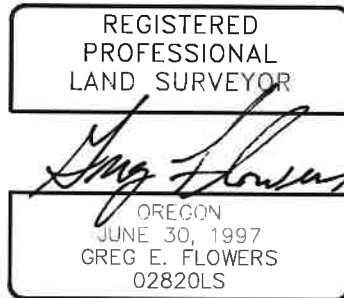

RENEWS 12/31/2025
1/18/2024