

OREGON CORNER RESTORATION FORM

Section: 20 – 21 – 28 – 29
Township: 5 North
Range: 28 East of the Willamette Meridian
County: Umatilla
Date: January 2024

Corner Indexing Information: Township 5N Range 28E Corner Code R-9 (Willamette Meridian)

Additional Identifier: Corner common to sections 20, 21, 28, 29

Oregon Plane Coordinates: N: 814098.37 E: 8500463.73 Zone: North Order: Second

Datum: NAD83-2011(epoch 2010) **Convergence:** N 00°49'51.74" W **Scale Factor:** 0.99995803471214

Previous Renewals/Surveys, etc.:

- 1861: Post, mound, pits, & charred stake (Davenport, General Land Office Contract #101)
- 1909: Not found; reset by double-proportion between R-1 & R-13, N-9 & Z-9 (J. Kimbrell, C.S. 283)
- 1910: Not found (J. Kimbrell, C.S. 313)
- 1911: Corner found, not described (J. Kimbrell, C.S. 336)
- 1917: Found 2" iron pipe, 2" above ground in place of and to perpetuate original corner, close to fence corner (Eriksen, G.L.O. letter 651680 "E" GCC, dated 2/17/1917)
- 1975: Found 2" iron pipe, locally recognized & accepted as best evidence of original corner. Replaced pipe w/ 2-1/2" iron post w/ brass cap, placed old pipe inside new post. (Tuers, Bureau of Land Management Group No. 864 Instructions dated 4-11-1975)
- 1990: Found Tuers' brass cap; Set (4) bearing tree signs & aluminum tag #951, in cedar fence post S61°W, 33.47', in 5" locust post N54°E, 1.20', in cedar fence post N35°W, 30.60', in telephone pole West, 58.91' (Edwards, LCR 91-001-B)
- 1998: Found monument & accessories per LCR 91-001-B; Set (2) 5/8" iron rebars w/ bearing tree sign & yellow plastic cap stamped "ORPLS 1106 WAPLS 17372" S25°E, 41.61', S30°W, 58.29'; Set steel fence post w/ witness post sign 1.0' beyond both iron rebars (W. Wells, LCR 98-101-C)

Monument(s) & Accessories Found (Condition & Source):

3-1/4" brass cap flush with ground; locust post stands 1' East. (2) 5/8" iron rebars w/ yellow plastic cap stamped "LS 1106" bears S27°01'58"W, 58.23', S27°10'23"E, 41.55'; T-posts w/ witness post signs stand 1' beyond each iron rebar. Utility pole w/ bearing tree sign bears N87°55'51"W, 58.47'.

Monument Set (Procedures & Description):

Found 3-1/4" brass cap as described above in good condition.

Monument Detail:

U.S DEPT. OF THE INTERIOR
T5N R28E
S20 | S21
S29 | S28
1975
CADASTRAL SURVEY
BUR. OF LAND MANAGEMENT

New Accessories: WE SET:

A 5/8" iron rebar w/ yellow plastic cap stamped "PBS WA19619 OR02820" bears N45°01'21"E, 30.0 feet from the corner. Rebar is flush with ground, attached bearing object sign to the rebar.

Location & Comments:

Monument falls between I-82 (McNary Highway) & Canal Road.

Compass Declination:

All accessories tied with State Plane grid bearings.

Firm/Agency: PBS Engineering & Environmental, Inc.
5 N. Colville Street
Walla Walla, WA 99362

Witness: Mark F. Wendover
Hayden J. Lomeli
Felipe G. Hernandez

Surveyor's Seal

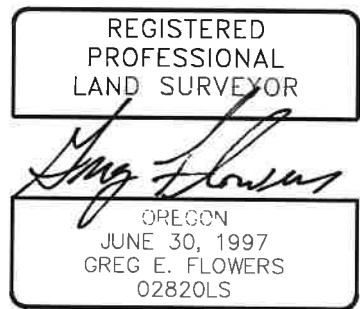

RENEWS 12/31/2025
1/18/2024