

**OREGON CORNER RESTORATION FORM**

**Section:** 26 – 27  
**Township:** 5 North  
**Range:** 28 East of the Willamette Meridian  
**County:** Umatilla  
**Date:** January 2024

**Corner Indexing Information:** Township 5N Range 28E Corner Code T-17 (Willamette Meridian)  
**Additional Identifier:** Quarter corner between Sections 26 & 27

**Oregon Plane Coordinates:** N: 811586.19 E: 8511118.11 **Zone:** North **Order:** Second  
**Datum:** NAD83-2011(epoch 2010) **Convergence:** N00°51'38"W **Scale Factor:** 1.000044268448

**Previous Renewals/Surveys, etc.:**

1861: Post, mound, pits, & charred stake (Davenport, General Land Office Contract #101)  
1911: Corner found, not described (J. Kimbrell, C.S. 330)  
1972: Established position by single-proportion between a computed position for R-17 and a pipe found at V-17 (Krumbein C.S. J-002-B)  
1988: "Found B.C. & W.C. N21°46'W 37.13' Krumbein 1973" attached bearing tag to power pole S44°12'W 15.97' (Edwards, C.S. 88-045-C)

**Monument(s) & Accessories Found (Condition & Source):**

2-1/2" brass cap 0.7' deep, 8'W x 9'S of the as-built intersection of Sagebrush Rd & Klaus Rd; T-post with witness post sign next to a railroad tie post at the NE corner of the intersection.

**Monument Set (Procedures & Description):**

N/A

**Monument Detail:**

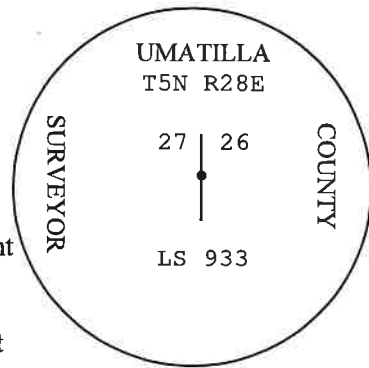

**New Accessories: WE SET:**

A 5/8" iron rebar with plastic cap stamped "PBS WA-19619 OR-02820" bears N22°06'28"W 66.57 feet from the corner; set T-post & bearing tag alongside.  
A 5/8" iron rebar with plastic cap stamped "PBS WA-19619 OR-02820" bears S63°25'33"W 33.88 feet from the corner; set bearing tag on adjacent fence post.  
A 5/8" iron rebar with plastic cap stamped "PBS WA-19619 OR-02820" bears S31°04'21"E 56.83 feet from the corner; set bearing tag on adjacent fence post.  
A 5/8" iron rebar with plastic cap stamped "PBS WA-19619 OR-02820" bears N35°46'19E 46.04 feet from the corner; set T-post & bearing tag alongside.

**Location & Comments:**

Corner falls in intersection Sagebrush & Klaus Rds.

**Compass Declination:**

All accessories tied with State Plane grid bearings.

**Firm/Agency:** PBS Engineering & Environmental, Inc  
5 N. Colville  
Walla Walla WA 99362

**Witness:** Mark F. Wendover  
Jered M. Clifford  
A.J. Nickels

**Surveyor's Seal**



*Greg E. Flowers*

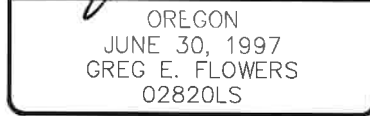

RENEWS 12/31/2025  
1/24/2024