

OREGON CORNER RESTORATION FORM

Section: 25 – 30
Township: 5 North
Range: 28 East & 29 East of the Willamette Meridian
County: Umatilla
Date: January 2024

Corner Indexing Information: Township 5N Range 28E Corner Code T-25/T-1 (Willamette Meridian)

Additional Identifier: East quarter corner of Section 25 R28E, West quarter corner Section 30 R29E

Oregon Plane Coordinates: N: 811632.80 E: 8521732.02 **Zone:** North **Order:** second
Datum: NAD83-2011(epoch 2010) **Convergence:** N00°53'25"W **Scale Factor:** 1.000044268448

Previous Renewals/Surveys, etc.:

- 1861: Set post, mound, pits, & charred stake (Davenport, General Land Office Contract #101)
- 1910: Corner found, not described (J. Kimbrell, C.S. 306)
- 1988: NF; set 1" iron pipe with brass cap by single-proportion between monuments found at R-25 & V-25; railroad-tie posts bear N45°37'W 34.35', S49°03'30"W 31.90' (Edwards, C.S. 88-045-C)
- 2005: Found monument per C.S. 88-045-C 10" below gravel surface; aluminum tags in railroad tie posts bear S49°15'22"W 31.87', N45°30'40"W 34.37'; set (2) 5/8" rebars with yellow plastic cap #951, N71°57'35"E 33.05', S34°31'06"E 54.59' (Edwards, LCR 06-265-C)

Monument(s) & Accessories Found (Condition & Source):

2-1/2" brass cap 4" deep, 5' west of centerline on N. Ott Road; railroad tie post with bearing tag marked "34.35 S4537E E1/4 25" bears N46°33'08"W, 34.43'; railroad tie post with bearing tag marked "31.90" bears S47°43'30"W, 32.05'; T-post with a bearing tag marked "54.59 N34 31 W 5N 29E W1/4 20 2005 LS 951" bears S51°47'50"E, 43.64'; a 5/8" iron rebar with a yellow plastic cap bears S35°32'42"E, 54.56' from the corner; a 5/8" iron rebar with plastic cap bears N69°08'41"E 29.51' from the corner.

Monument Set (Procedures & Description):

N/A

Monument Detail:

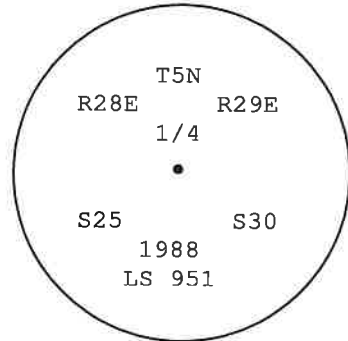

New Accessories: WE SET:

N/A

Location & Comments:

Corner lies +-2650' Northerly along N. Ott Road from the intersection of N. Ott Road and W. Walls Road, lying at the mouth of a Westerly gravel driveway.

Compass Declination:

All accessories tied with State Plane grid bearings.

Firm/Agency: PBS Engineering & Environmental, Inc
5 N. Colville
Walla Walla WA 99362

Witness: Mark F. Wendover
Felipe Hernandez
Hayden Lomeli

Surveyor's Seal

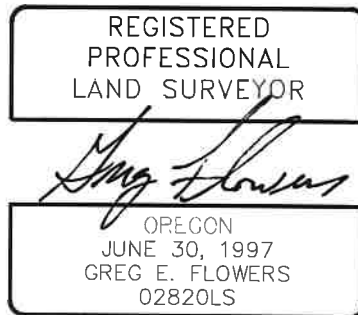

RENEWS 12/31/2025
02/01/2024