

**OREGON CORNER RESTORATION FORM**

SECTION:33 TOWNSHIP: 5N

RANGE: 29E

X-13

COUNTY: UMATILLA

DATE: 12/05

**CORNER DESIGNATION**

*E1/4 Section 33*

- CONDITION REPORT ONLY
- NOT FOUND
- RENEWED
- UNRECORDED
- SURVEYED IN
- REFERENCED OUT

**PREVIOUS RENEWALS/SURVEYS ETC.**

Originally surveyed by Davenport under Contract # 101 in 1861. He set post and made mound.  
In 1913 Kimbrell set 2" iron pipe.

In 2002 Edwards drove 5/8" iron rebar into 2" iron pipe.

**MONUMENTS AND ACCESSORIES FOUND: CONDITION AND SOURCE**

Found 5/8" iron rebar 5" below the surface of a graveled road.

W.C. found aluminum tag # 951 in a power pole bears S 56° 06' 32" W 41.38'(41.38')

W.C. found aluminum tag # 951 in a power pole bears S 32° 02' 09" E 28.16'(28.40')

**MONUMENT DETAIL**

T5NR29E

1/4

33 34

**OREGON STATE PLANE COORDINATES, NORTH ZONE, NAD 83(91) INT. FEET:**

806603.24

8537755.66

**MONUMENT SET (PROCEDURES AND DESCRIPTION)**

**NEW ACCESSORIES FROM WHICH**

A 5/8" x 30" Iron Rebar with plastic cap #951 bears S 45° 42' 03" W 31.43'

A 5/8" x 30" Iron Rebar with plastic cap #951 bears S 33° 31' 03" E 24.36'

**LOCATION AND COMMENTS**

At the intersection of Tabor road and Columbia Lane.

SURVEYOR'S SEAL

**FIRM: EDWARDS SURVEYING LLC  
PO BOX 763 - HERMISTON OR 97838**

**PARTY CHIEF: R. SMITH  
WITNESS: J. JOSEPH**

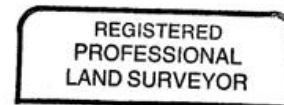

*G. Dennis Edwards*

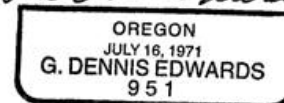

RENEWS 12/31/05