

**OREGON CORNER RESTORATION FORM**

SECTION:33    TOWNSHIP: 5N    RANGE: 29E    Z-13

COUNTY: UMATILLA    DATE: 12/05

**CORNER DESIGNATION**

SE Section 33

- CONDITION REPORT ONLY
- NOT FOUND
- RENEWED
- UNRECORDED
- SURVEYED IN
- REFERENCED OUT

**PREVIOUS RENEWALS/SURVEYS ETC.**

Originally surveyed by Maxon & Hurd under Contract # 50 in 1860. They set post and made mound. In 1990 I set a 2 1/2" brass cap in concrete over a 1 1/4" iron pipe of unknown origin.

**MONUMENTS AND ACCESSORIES FOUND: CONDITION AND SOURCE**

Found 2 1/2" brass cap stamped as below 6" below the surface.  
 W.C. an aluminum tag in a R/R tie bears N 59° E 1.10'  
 W.C. an aluminum tag in a R/R tie bears N 88° 44' 26" E 57.86'(57.86')  
 W.C. a 2 1/2" brass cap bears N 0° 00' 08" W 12.00'(12.00')

**MONUMENT DETAIL**

T5NR29E  
 33 | 34  
 1990  
 L.S. 951

**OREGON STATE PLANE COORDINATES, NORTH ZONE, NAD 83(91) INT. FEET:**

803962.38  
 8537802.53

**MONUMENT SET (PROCEDURES AND DESCRIPTION)**

**NEW ACCESSORIES FROM WHICH**

A 5/8" x 30" Iron Rebar with plastic cap #951 bears N 0° 53' 40" E 107.66'

**LOCATION AND COMMENTS**

At the fence corner on the Southeasterly projection of Tabor road and the Easterly projection of Punkin Center road.

SURVEYOR'S SEAL

FIRM: EDWARDS SURVEYING LLC  
 PO BOX 763 - HERMISTON OR 97838

PARTY CHIEF: R. SMITH  
 WITNESS: J. JOSEPH

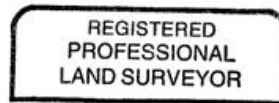

*G. Dennis Edwards*

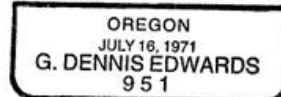

RENEWS 12/31/05