

**OREGON CORNER RESTORATION FORM**

COUNTY: Umatilla DATE: 04/01/04

CORNER DESIGNATION: V-15, The North One-Quarter Corner of Section 34, T5N., R33E., W.M.

PREVIOUS RENEWALS/SURVEYS ETC.: Corner originally established by William H. Odell and William L. Lewis, U.S. Deputy Surveyors under Contract No. 110, dated February 7, 1865. Record states: Set 1/4 Sec. post. Drove charred stake; dug pits and raised mound as per instructions.

MONUMENT AND ACCESSORIES FOUND: None. Corner position was reestablished at extended intersection of field lines/berms extending South and East. Confirmed reestablished corner position against record tie from 1888 Northern Pacific Railroad Map. (See accompanying plat).

MONUMENT MARKING DETAIL:

T5N R33E  
1/4 S27  
S34  
2004  
PLS 1106

MONUMENT SET: At position determined as described, set a 2 1/2" brass cap (marked as shown in "Monument Marking Detail"), on a 1 1/4" x 30" galvanized iron pipe, 30" in the ground and surrounded with earth.

New accessories to corner monument:

A 5/8" x 30" iron rebar with yellow plastic cap marked "OR PLS 1106, WA PLS 17372", set flush with ground level bears N 34° E, 39.1 feet.

A 5/8" x 30" iron rebar with yellow plastic cap marked "OR PLS 1106, WA PLS 17372", set flush with ground level bears East, 37.2 feet.

A 5/8" x 30" iron rebar with yellow plastic cap marked "OR PLS 1106, WA PLS 17372", set flush with ground level bears S 10° W, 39.3 feet.

A 5/8" x 30" iron rebar with yellow plastic cap marked "OR PLS 1106, WA PLS 17372", set flush with ground level bears N 40° W, 38.6 feet.

Attached bearing object signs to rebar accessories. Set steel fence post with witness sign attached, 1 foot North of the corner monument.

LOCATION AND COMMENTS: Corner is located in an un-farmed field corner, with farmed field lines extending South and East. Found old down locust fence post and several down wood fence posts nearby.

FIRM: William R. Wells, PLS  
P.O. Box 1696  
Pendleton, OR 97801

COMPASS DECLINATION: 18° East

Surveyor's Seal

Witnesses: Jason Wells, LSIT  
Mark Hammersla

5N33V15

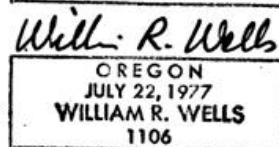
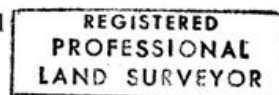

RECEIVED BY  
Umatilla County Surveyor  
Date 4-04  
Rec'd By KK  
No. 04-26-B

renews 6-30-04