

OREGON CORNER RESTORATION FORM

Section 9 Township 5N Range 34E
 County Umatilla Date: June 12, 2003

Condition Report Only
 Not found
 Remonumented
 Unrecorded
 Surveyed in
 Referenced out

Corner Designation: 5N34E13
 Corner to sections 3, 4, 9, and 10, T5N, R34E,
 W.M., Umatilla County, Oregon.

State Plane Coordinates, Oregon North, 83(1991) from a
 single GPS tie to Tri Station GEER, N = 832099.28 E = 8695853.37

Previous Renewals / Surveys, etc.
 Corner originally set by Wm. H. Odell & Wm. S. Lewis under contract No. 110 dated February
 7th, 1865. Their record reads: Set post Cor. for Secs. 3, 4, 9, & 10. Drove Charred Stake; Dug pits
 and raised mound, as per instructions. C.E. Macomber in the survey in Book 1, Page 466 of the
 record of private surveys calls "set stone 16 x 12 x 8". In the survey in Book 2, Page 276, Willard
 Bradley calls "set large stone, 500# +/-, "x" on top for corner."

Monument and Accessories found: (condition and source)
 The basalt stone set by Bradley, 27 x 21 x 12 ins., plainly marked "x". It had been moved as the "x"
 was on the side and covered by dirt.

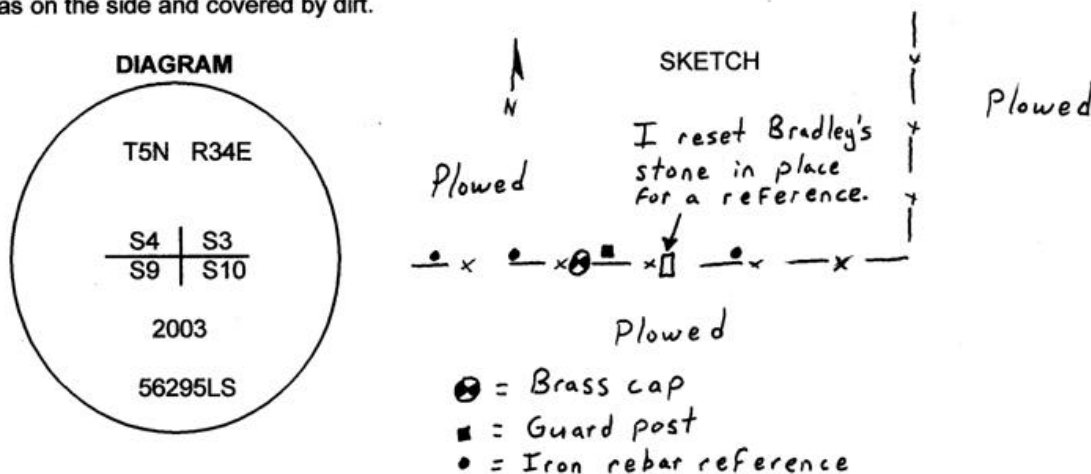

MONUMENT (S) AND ACCESSORIES SET (Procedures and Description)
 I set a 1 1/2" x 30" galvanized iron pipe with a 2 1/4" brass cap stamped as shown in the diagram
 above at the position calculated from Bradley's calls to the fences. I reset Bradley's stone where
 it was for a bearing object and set a 5" steel guard post with a County Monument sign attached
 along side.

For references, I set three, 5/8" by 24" iron rebars with 1.25" orange plastic caps stamped WTS
 and 56295LS as described below:
 a rebar bears N88°11'18"E, 55.38 feet;
 a rebar bears S89°46'12"W, 29.66 feet;
 a rebar bears S88°48'22"W, 59.06 feet;
 Bradley's stone bears N89°07'57"E, 27.18 feet under the existing fence;

The monument and references were tied using a LIECA system 300 RTK GPS.

Location and comments

Compass Declination

Surveyors Seal

RECEIVED BY:
Umatilla County Surveyor
 Date: 10-03
 Rec'd By: KK
 No. 03-319-C

Firm / Agency
 Witness Tree Surveying
 Address
 P.O. Box G
 Pilot Rock, Or. 97868
 Party Chief
 Stephen K, Haddock

REGISTERED
 PROFESSIONAL
 LAND SURVEYOR

Stephen K. Haddock

OREGON
 JULY 9, 2001
 STEPHEN K. HADDOCK
 56295LS

RENEWAL DATE 6-30-05