

OREGON CORNER RESTORATION FORM

Section 8 Township 5N Range 34E
 County Umatilla Date: March 13, 2003

Corner Designation: 5N34E9

Corner to sections 4, 5, 8, and 9, T5N, R34E,
 W.M., Umatilla County, Oregon.

Condition Report Only
 Not found
 Remonumented
 Unrecorded
 Surveyed in
 Referenced out

State Plane Coordinates, Oregon North, 83(1991) from a
 single GPS tie to Tri Station GEER, N = 831825.16 E = 8690552.05

Previous Renewals / Surveys, etc.

Corner originally set by Wm. H. Odell & Wm. S. Lewis under contract No. 110 dated February 7th, 1865. Their record reads: Set post Cor. for Secs. 4, 5, 8, & 9. Drove Charred Stake; Dug pits and raised mound, as per instructions. John Kimbrell in the survey in Book 1, Page 36 of the record of private surveys calls for an old post with traces of fences running east and north. Willard Bradley in the survey in Book 2, Page 276 of the record of private surveys calls for a stone set by George Winkle in the center road south and east. Aubrey Perry in the survey recorded in the record of private surveys Book 2, Page 310 calls for a rock buried in centerline of road set by Winkle.

Monument and Accessories found: (condition and source)

A 12" diameter spherical basalt stone at the corner of fences running North and East.

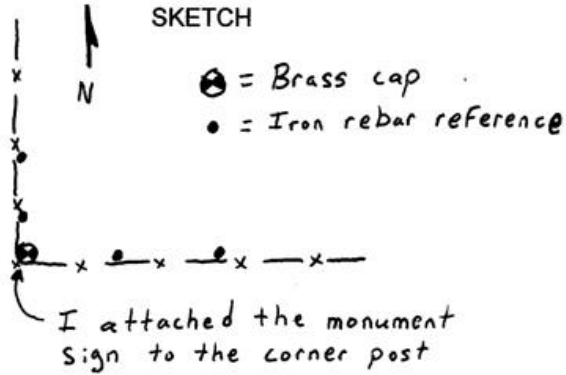
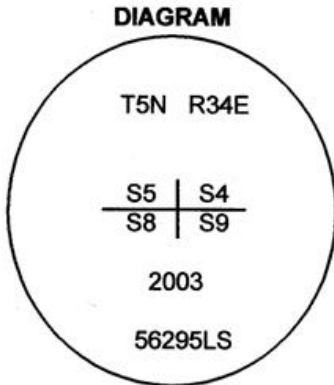

MONUMENT (S) AND ACCESSORIES SET (Procedures and Description)

I set a 1 1/2" x 30" galvanized iron pipe with a 2 1/4" brass cap stamped as shown in the diagram above at the position of the stone. I marked the brass cap with the wrong sections the first time so I obliterated those marks and remarked the cap properly. I buried the stone along side.

For references, I set four, 5/8" by 24" green coated iron rebars with 1.25" orange plastic caps stamped WTS and 56295LS as described below:

- a rebar bears N1°40'53"W, 53.70 feet;
- a rebar bears N3°22'27"W, 25.12 feet;
- a rebar bears N89°50'24"E, 57.98 feet;
- a rebar bears S88°43'06"E, 27.65 feet;

The monument and references were tied using a LIECA system 300 RTK GPS.

Location and comments

Compass Declination

Surveyors Seal

RECEIVED BY:
Umatilla County Surveyor
 Date: 10-03
 Rec'd By: KE
 No. 03-3131-C

Firm / Agency
 Witness Tree Surveying
 Address
 P.O. Box G
 Pilot Rock, Or. 97868
 Party Chief
 Stephen K, Haddock

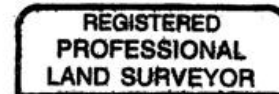

Stephen K. Haddock

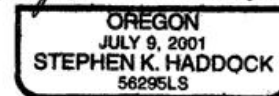

RENEWAL DATE 6-30-05