

OREGON CORNER RESTORATION FORM

Section 10 Township 5N Range 34E
 County Umatilla Date: April 15, 2003

Corner Designation: 5N34J17

Corner to sections 10, 11, 14, and 15, T5N, R34E,
 W.M., Umatilla County, Oregon.

Condition Report Only
 Not found
x Remonumented
 Unrecorded
 Surveyed in
x Referenced out

State Plane Coordinates, Oregon North, 83(1991) based on a
 single GPS tie to Tri Station GEER, N = 827099.83 E = 8701350.60

Previous Renewals / Surveys, etc.

Corner originally set by Wm. H. Odell & Wm. S. Lewis under contract No. 110 dated February 7th, 1865. Their record reads: Set post Cor. for Secs. 10, 11, 14, & 15. on steep hillside sloping to N. Drove charred stake; dug pits and raised mound, as per instructions. Willard Bradley in the survey in Book 2, Page 276 of the record of private surveys said "found charred stake at fence intersection, fence E., W., N. & S.. Set two stones over charred remains of stake..

Monument and Accessories found: (condition and source)

I found a 3 way fence intersection with fences running East, West, and South. There was some wire to indicate a fence to the North but no precise location of that fence could be determined.

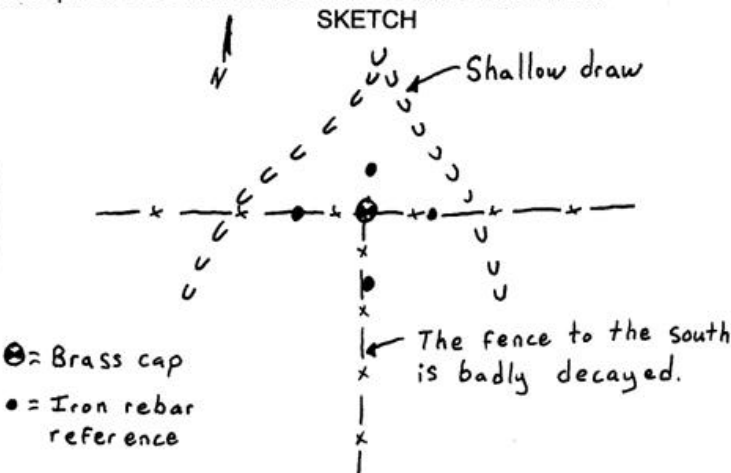
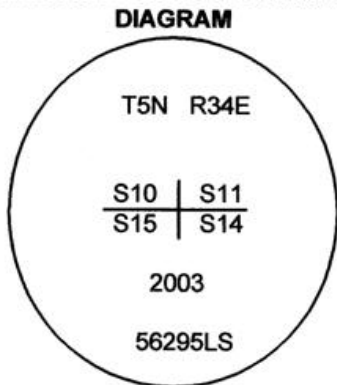

MONUMENT (S) AND ACCESSORIES SET (Procedures and Description)

I set a 1 1/2" x 30" galvanized iron pipe with a 2 1/4" brass cap stamped as shown in the diagram above at the fence corner. I attached a County Monument sign to the fence wire.

For references, I set four, 5/8" by 24" green coated iron rebars with 1.25" orange plastic caps stamped WTS and 56295LS as described below:

- a rebar bears N2°55'03"E, 19.62 feet;
- a rebar bears S89°26'27"E, 21.17 feet;
- a rebar bears N89°27'36"W, 26.97 feet;
- a rebar bears S3°07'03"E, 35.12 feet;

The monument and references were tied using a LIECA system 300 RTK GPS.

Location and comments

Compass Declination

Surveyors Seal

RECEIVED BY:
Umatilla County Surveyor
 Date: 10-03
 Rec'd By: KK
 No. 03-314-C

Firm / Agency
 Witness Tree Surveying
 Address
 P.O. Box G
 Pilot Rock, Or. 97868
 Party Chief
 Stephen K, Haddock

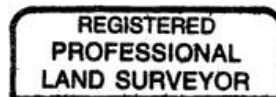

Stephen K. Haddock

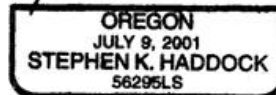

RENEWAL DATE 6-30-05