

**OREGON CORNER RESTORATION FORM**

Section 24 Township 5N Range 34E  
 County Umatilla Date: April 19, 2003

Corner Designation: 5N34P25

Quarter corner common to section 24, T5N, R34E and section 19, T5N, R35E, W.M., Umatilla County, Oregon.

Condition Report Only  
 Not found  
 Remonumented  
 Unrecorded  
 Surveyed in  
 Referenced out

State Plane Coordinates, Oregon North, 83(1991) based on a single GPS tie to Tri Station GEER, N = 819443.49 E = 8712265.44

Previous Renewals / Surveys, etc.

Corner originally set by Deputy Surveyors Odell & Lewis under contract No. 110 dated February 7th, 1865. Their record reads: Set 1/4 sec. post on hillside facing E. Drove charred stake, dug pits and raised mound as per instructions.

Monument and Accessories found: ( condition and source )  
 A fence corner with fences running North, East, and West.

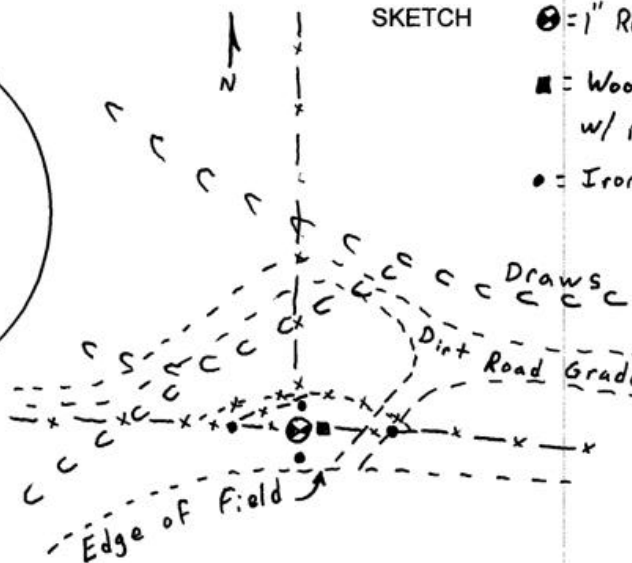
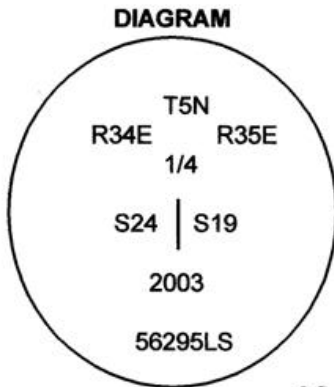

SKETCH  
 ⊙ = 1" Rebar w/ Al. cap  
 ■ = Wood guard post w/ monument sign  
 ● = Iron rebar reference

**MONUMENT (S) AND ACCESSORIES SET (Procedures and Description)**

I set a 1" x 24" iron rebar with a 2" aluminum cap stamped as shown in the diagram above in the decayed remains of the old fence corner.

For references, I set four 5/8" by 24" iron rebars with 1 1/8" orange plastic caps stamped WTS and 56295LS as described below:

- a rebar bears S79°20'59"W, 41.63 feet;
- a rebar bears N6°19'30"E, 7.98 feet;
- a rebar bears S4°52'52"W, 16.62 feet;
- a rebar bears S89°18'37"E, 37.67 feet;

The monument and references were tied using a LIECA system 300 RTK GPS.

Location and comments

Compass Declination

Surveyors Seal

RECEIVED BY:  
 Umatilla County Surveyor  
 Date: 10-03  
 Rec'd By: KK  
 No. 03-314-C

Firm / Agency  
 Witness Tree Surveying  
 Address  
 P.O. Box G  
 Pilot Rock, Or. 97868  
 Party Chief  
 Stephen K. Haddock

REGISTERED  
 PROFESSIONAL  
 LAND SURVEYOR

*Stephen K. Haddock*

OREGON  
 JULY 9, 2001  
 STEPHEN K. HADDOCK  
 56295LS

RENEWAL DATE 6-30-05