

**OREGON CORNER RESTORATION FORM**

COUNTY: Umatilla DATE: 05/06/09

CORNER DESIGNATION: R-5, The Southwest Corner of Section 20, Township 5 North, Range 34 East, W.M.

PREVIOUS RENEWALS/SURVEYS ETC.: Corner originally established by Odell & Lewis under GLO Contract No. 110, dated February 7, 1865.  
Notes state: Set a post corner for secs 19, 20, 29 & 30, Land slopes to the West. Drove charred stake, dug pits and raised mound as per instructions.  
Corner found on Harris Survey Q-783-C, states: Found fence corner which is accepted as section corner.

MONUMENT AND ACCESSORIES FOUND: None.

MONUMENT MARKING DETAIL:

T5N R34E  
S19 | S20  
S30 | S29  
2009  
PLS 1106

MONUMENT SET: At reestablished corner point, set a 2 3/8" diameter brass monument on a 1 1/4" x 30" galvanized iron pipe, with cap 18" below ground level, marked as shown in "Monument Marking Detail".

New Accessories:

A silver deep-1 magnet bears North 33 1/4° East, a distance of 12.5 feet.  
A pink deep-1 magnet bears South 57° East, a distance of 14.4 feet.  
A blue deep-1 magnet bears South 21 1/4° West, a distance of 16.8 feet.  
An orange deep-1 magnet bears North 39° West, a distance of 13.8 feet.  
All deep-1 magnets are buried 24" below ground level with bearing object signs nearby. Set steel fence post 3 feet North of corner with witness sign.

LOCATION AND COMMENTS: Located in farmed wheat fields. Old field berms extend South and East. Fainter field berms extend North and West.

OREGON STATE PLANE COORDINATE, North Zone, NAD 83(91), International Feet:

N = 816377.09  
E = 8686128.34

FIRM: Wells Surveying  
P.O. Box 1696  
Pendleton, OR 97801

COMPASS DECLINATION: 18° East

Witnesses: Matt Brockamp  
D. Palmer

5N34R5

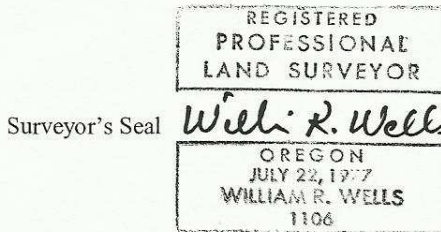

RENEWS 6-30-12

**RECEIVED BY**  
Umatilla County Surveyor  
Date: 4/3/2012  
Rec'd By: Dave Tolbert  
No.: 12-029-C