

OREGON CORNER RESTORATION FORM

COUNTY: Umatilla DATE: 03/24/05

CORNER DESIGNATION: 5N35, N-11, The South Quarter Corner of Section 16.

PREVIOUS RENEWALS/SURVEYS ETC.:

Corner originally established by Odell & Lewis, under GLO Contract No. 110, dated February 7, 1865. Notes state: Set 1/4 Sec. post; drove charred stake; dug pits & raised mound, as per instructions.

MONUMENT AND ACCESSORIES FOUND: None.

MONUMENT MARKING DETAIL:

T5N R35E

1 S16

4 S21

2005

PLS 1106

MONUMENT SET:

The corner area has been extensively farmed. There is a East-West fence line and field berm between existing fields. I re-establish this corner position perpendicular to the midpoint of a line between the Northwest and Northeast corners of Section 21, holding the existing East-West fence line for latitude. At the re-established corner position, set a 2 1/2" brass cap on a 1 1/4" x 30" galvanized iron pipe, 28" in the ground.

New accessories:

A 5/8" x 24" rebar with a yellow plastic cap marked "OR PLS 1106, WA PLS 17372", bears South 88° East, 23.3 feet.

A 5/8" x 24" rebar with a yellow plastic cap marked "OR PLS 1106, WA PLS 17372", bears South 88° East, 47.9 feet.

A 5/8" x 24" rebar with a yellow plastic cap marked "OR PLS 1106, WA PLS 17372", bears North 88° West, 23.6 feet.

A 5/8" x 24" rebar with a yellow plastic cap marked "OR PLS 1106, WA PLS 17372", bears North 88° West, 52.4 feet.

Wired bearing object signs to rebar accessories. Wired "witness" sign to steel fence post 4 feet West of monument. Accessories are in East-West fence line.

LOCATION AND COMMENTS: Corner located in East-West fence line, between farmed fields.

OREGON STATE PLANE COORDINATE, North Zone, NAD 83(91), International Feet:

N = 822353.02

E = 8725659.38

FIRM: William R. Wells, PLS

P.O. Box 1696

Pendleton, OR 97801

COMPASS DECLINATION: 18° East

Surveyor's Seal

Witness: Jason Wells, LSIT

/5N35N11

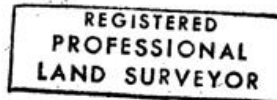

William R. Wells
OREGON
JULY 22, 1977
WILLIAM R. WELLS
1106
RENEWS 6/30/06