

OREGON CORNER RESTORATION FORM

COUNTY: Umatilla DATE: 03/08/05

CORNER DESIGNATION: 5N35, N-13, The Southeast Corner of Section 16.

PREVIOUS RENEWALS/SURVEYS ETC.:

Corner was originally established by Odell & Lewis, under GLO Contract No. 110, dated February 7, 1865. Notes state: Set post Cor. for Secs. 15, 16, 21 & 22; drove charred stake; dug pits & raised mound, as per instructions.

MONUMENT AND ACCESSORIES FOUND: None.

MONUMENT MARKING DETAIL:

T5N R35E
S16 | S15
S21 | S22
2005
PLS 1106

MONUMENT SET:

Held a fence corner with fences North and West as best remaining evidence of original corner. Set 2 1/2" brass cap on a 1 1/4" x 30" galvanized iron pipe 18" in the ground and surrounded with a mound of stones. Cap marked as shown in Monument Marking Detail.

New accessories:

A 5/8" x 24" iron rebar with a 1 1/4" yellow plastic cap marked "OR PLS 1106, WA PLS 17372", cap 2" above ground level bears East 24.3 feet.

"XBO" chiseled in top of a 16" x 16" x 12" immovable rock, bears South 31° E, 46.4 feet. Measured to "X".

A 5/8" x 24" iron rebar with a 1 1/4" yellow plastic cap marked "OR PLS 1106, WA PLS 17372", bears South 87° West, 27.7 feet.

A 5/8" x 24" iron rebar with a 1 1/4" yellow plastic cap marked "OR PLS 1106, WA PLS 17372", cap 2" above ground level bears North 02° West, 28.8 feet.

Attached bearing object signs to the rebar accessories. Nailed a "witness" sign to fence corner post East of the monument.

LOCATION AND COMMENTS: Corner monument is located 0.8 feet East of a fence corner with fences West and North.

OREGON STATE PLANE COORDINATE, North Zone, NAD 83(91), International Feet:

N = 822370.95
E = 8728508.80

FIRM: William R. Wells, PLS
P.O. Box 1696
Pendleton, OR 97801

COMPASS DECLINATION: 18° East

Surveyor's Seal

Witnesses: Jason Wells, LSIT
Brian Cole

/5N35N13

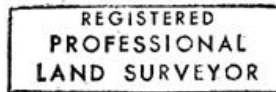

William R. Wells
OREGON
JULY 22, 1977
WILLIAM R. WELLS
1106

Renews 6/30/06

05-112-C