

OREGON CORNER RESTORATION FORM

COUNTY: Umatilla DATE: 02/08/05

CORNER DESIGNATION: 5N35, R-15, The South Quarter Corner of Section 22.

PREVIOUS RENEWALS/SURVEYS ETC.:

Corner originally established by Odell & Lewis, under GLO Contract No. 110, dated February 7, 1865. Notes state: Set 1/4 Sec. post; drove charred stake; dug pits & raised mound, as per instructions.

The corner was recovered in Record of Private Surveys, Survey No. 124, by J.W. Kimbrell, during his subdivision of Section 22.

MONUMENT AND ACCESSORIES FOUND: None.

MONUMENT MARKING DETAIL:

T5N R35E
1 S22
4 S27
2005
PLS 1106

MONUMENT SET:

The corner falls in a wheat field. I re-established this corner by single proportion measurement between the Southwest and Southeast corners of Section 22. At the re-established corner position, set a 2 1/2" brass cap on a 1 1/4" by 30" galvanized iron pipe with cap 15" below ground, marked as shown in Monument Marking Detail.

New accessories:

A silver deep-1 magnet buried 2.0 feet below ground, bears North 30° East, 30.4 feet.
A purple deep-1 magnet buried 2.0 feet below ground, bears South 52° East, 43.5 feet.
A blue deep-1 magnet buried 2.1 feet below ground, bears South 34° West, 35.7 feet.
An orange deep-1 magnet buried 2.1 feet below ground, bears North 55° West, 43.6 feet.
Buried bearing object signs with deep-1 magnets.

LOCATION AND COMMENTS: Corner is located Northeast, 55 feet, from the centerline of a field road. Corner is on line with York Road to the South. The Northeast leg of an old windmill bears South 84° West, 396.3 feet from corner.

OREGON STATE PLANE COORDINATE, North Zone, NAD 83(91), International Feet:

N = 817115.90
E = 8731121.74

FIRM: William R. Wells, PLS
P.O. Box 1696
Pendleton, OR 97801

COMPASS DECLINATION: 18° East

Witness: Brian Cole

/5N35R15

Surveyor's Seal

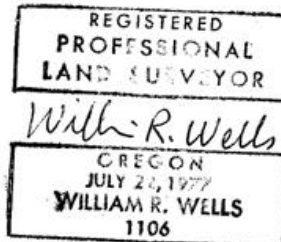

Renews 6/30/06