

**OREGON CORNER RESTORATION FORM**

COUNTY: Umatilla DATE: 02/08/05

CORNER DESIGNATION: 5N35, V-11, The South Quarter Corner of Section 28.

**PREVIOUS RENEWALS/SURVEYS ETC.:**

Corner originally established by Odell & Lewis, under GLO Contract No. 110, dated February 7, 1865. Notes state: Set post Cor. for 1/4 Sec.; drove charred stake; dug pits; raised mound, as per instructions.

In Record of Private Surveys, Survey No. 106, J.W. Kimbrell recovers this corner, but does not state what was recovered. Survey No 182 reports identical dimensions to Survey No. 106. Survey No 106 was made in 1899.

In Record of Private Surveys, at Book 1, pages 133 & 134, (No Survey No.), Peter Zahner does not recover this corner and re-established it in 1885. Kimbrell's record above supercedes this.

MONUMENT AND ACCESSORIES FOUND: None.

**MONUMENT MARKING DETAIL:**

T5N R35E

1 S28

4 S33

2005

PLS 1106

**MONUMENT SET:**

I re-establish this corner by single proportion measure between the Southeast and Southwest corners of Section 28, using record dimensions from Survey No. 106. I note Kimbrell, in Survey No. 106, indicates this corner is 43 links South of true line between the Southeast and Southwest corners of Section 28. But, since I held road and field line evidence to re-establish the Southeast and Southwest corners of Section 28, and did not find Kimbrell's corner monuments, making the 43 link offset would be an exercise in absurdity when considering Kimbrell would have used a compass, or at best a solar compass, to determine bearings and line in his retracements. At re-established corner position, set a 2 1/2" brass cap on a 2 1/2" x 30" galvanized iron pipe with cap 28" in the ground and surrounded with a mound of earth and stone. Cap marked as shown in Monument Marking Detail.

**New accessories:**

A brass washer stamped "PLS 1106" on an 8 foot high sawed off power pole, 1.0 feet above ground level, bears North 51° West, 9.8 feet.

A brass washer stamped "PLS 1106" on an 8 foot high sawed off power pole, 1.0 feet above ground level, bears North 16° East, 41.6 feet.

A brass washer stamped "PLS 1106" on a PP&L pole #285000, 1.0 above ground level on West side, bears North 31° East, 13.5 feet.

A brass washer stamped "PLS 1106" on an 8 foot high sawed off power pole, 1.0 feet above ground level on North side, bears South 80° East, 78.5 feet.

Attached bearing object signs to all pole accessories. Set steel fence post 2 feet North of corner monument with "witness" sign attached.

**LOCATION AND COMMENTS:** Corner is 18 feet North of East-West Road with bend in it. Corner is 5 feet West of power line and field line North. Corner is 7 feet West of power line and fence line South.

**OREGON STATE PLANE COORDINATE, North Zone, NAD 83(91), International Feet:**

N = 811746.77

E = 8725116.02

**FIRM:** William R. Wells, PLS

P.O. Box 1696

Pendleton, OR 97801

**COMPASS DECLINATION:** 18° East

Surveyor's Seal

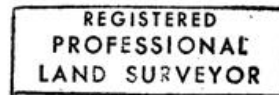

*William R. Wells*

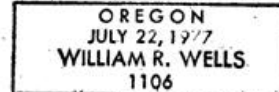

RLnews 6/30/06

**Witnesses:** Brian Cole  
/5N35V11

05-112-c