

OREGON CORNER RESTORATION FORM

COUNTY: Umatilla DATE: 01/27/05

CORNER DESIGNATION: 5N35, V-15, The South Quarter Corner of Section 27.

PREVIOUS RENEWALS/SURVEYS ETC.:

Corner originally established by Odell & Lewis, under GLO Contract No. 110, dated February 7, 1865. Notes state: Set post; drove charred stake; dug pits & raised mound, as per instructions.

MONUMENT AND ACCESSORIES FOUND: Road intersection with York Road running North-South and Staggs Road running West.

MONUMENT MARKING DETAIL:

T5N R35E
1/4 S27
S34
2005
PLS 1106

MONUMENT SET: I held the intersection of York Road, running North-South and Staggs Road, running West, as best remaining evidence of the original corner location. At the corner point, set a 2 1/2" brass cap on a 1 1/4" by 30" galvanized iron pipe, with cap buried 10 inches below road surface. Cap marked as shown in Monument Marking Detail.

New accessories:

A 5/8" x 24" iron rebar with a 1 1/4" yellow plastic cap marked "OR PLS 1106, WA PLS 17372", cap 1" above ground level bears North 17 1/2° East, 52.5 feet.

The center of a phone pedestal measured at ground level bears South 13° East, 106.2 feet.

A 5/8" x 24" iron rebar with a 1 1/4" yellow plastic cap marked "OR PLS 1106, WA PLS 17372", bears South 43° West, 44.8 feet.

A 5/8" x 24" iron rebar with a 1 1/4" yellow plastic cap marked "OR PLS 1106, WA PLS 17372", bears North 33° West, 42.7 feet.

Attached bearing object signs to all rebar accessories. Set steel fence post with "witness" by rebar accessory Northwest quadrant.

LOCATION AND COMMENTS: At visual centerline of a road intersection with York Road running North-South and Staggs road running West.

OREGON STATE PLANE COORDINATE, North Zone, NAD 83(91), International Feet:

N = 811843.21
E = 8731175.37

FIRM: William R. Wells, PLS
P.O. Box 1696
Pendleton, OR 97801

COMPASS DECLINATION: 18° East

Surveyor's Seal

Witnesses: Jason Wells, LSIT
Brian Cole

/5N35NV15

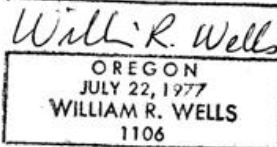
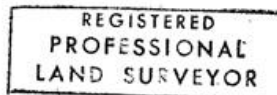

Renews 6/30/06

05-112-C