

OREGON CORNER RESTORATION FORM

COUNTY: Umatilla DATE: 05/13/03

CORNER DESIGNATION: V-1, The Southwest Corner of Section 30, Township 5 North, Range 36 East, W.M.

PREVIOUS RENEWALS/SURVEYS ETC.:

Corner was originally established by Odell & Lewis under GLO Contract No. 110, dated February 7, 1865. Record states: Set post Cor. for Secs. 25 & 36, 30 & 31, on hill, facing E.; drove charred stake; dug pits and raised mound, as per instructions.

MONUMENT AND ACCESSORIES FOUND:

Found old 10" long bridge spike 3" below gravel surface at a four way road intersection (Intersection of Basket Mountain Road and Blue Mountain Station Road). Survey No. 00-45-B had held the 4 way road intersection as the corner but no monument was set. The origin of the bridge spike is unknown.

MONUMENT MARKING DETAIL:

T5N
R35E R36E
S25 | S30
S36 | S31
2003
PLS 1106

MONUMENT SET:

Upon digging the monument hole, found a old diagonal culvert about 14" below road surface. I filled the hole with concrete and set a 2 1/2" brass disk with cap buried 6" below road surface. Monument is marked as shown in "Monument Marking Detail".

New accessories:

- The center top of a US West phone box bears N 34° E, 28.8 feet.
- The base of a stop sign post bears S 20° E, 51.3 feet.
- A 5/8" x 30" iron rebar with a yellow plastic cap stamped "OR PLS 1106, WA PLS 17372", with cap 2" above ground level bears S 47° W, 34.3 feet.
- The base of a yield sign post (with road signs) bears N 40°W, 38.4 feet.
- Wired bearing object sign to 5/8" iron rebar accessory.

LOCATION AND COMMENTS:

Corner is located at the intersection of Basket Mountain Road (North-South) and Blue Mountain Station Road (East-West).

FIRM: William R. Wells, PLS
P.O. Box 1696
Pendleton, OR 97801

COMPASS DECLINATION: 18° East

Surveyor's Seal

Witnesses: Jason Wells, LSIT
Mark Hammersla
V5N36V1

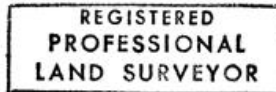

William R. Wells

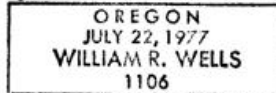

renews 6-30-04

RECEIVED BY
Umatilla County Surveyor
Date 5-03
Rec'd By KK
No. 03-65-B