

OREGON CORNER RESTORATION FORM

COUNTY: Umatilla DATE: 03/08/05

CORNER DESIGNATION: 5N35, X-17, The East Quarter Corner of Section 34.

PREVIOUS RENEWALS/SURVEYS ETC.:

Corner originally established by Odell & Lewis, under GLO Contract No. 110, dated February 7, 1865. Notes state: Set post for 1/4 Sec. Cor. Drove charred stake; dug pits & raised mound, as per instructions.

MONUMENT AND ACCESSORIES FOUND: None.

MONUMENT MARKING DETAIL:

T5N R35E
1/4
S34 | S35
2005
PLS 1106

MONUMENT SET:

Corner falls in a wheat field with no nearby features. I re-establish this corner by single proportion measurement between the Northeast and Southeast corners of Section 34. At the re-established corner position, set a 2 1/2" brass cap on a 1 1/4" by 30" galvanized iron pipe with cap 20" below ground level, marked as shown in Monument Marking Detail.

New accessories:

A silver deep-1 magnet, buried 20" in ground, bears North 37° East, 34.7 feet.
A purple deep-1 magnet, buried 20" in ground, bears South 51° East, 37.4 feet.
A blue deep-1 magnet, buried 20" in ground, bears South 42° West, 36.0 feet.
An orange deep-1 magnet, buried 20" in ground, bears North 57° West, 38.8 feet.
Buried bearing object signs with deep-1 magnets.

LOCATION AND COMMENTS: Corner falls in a actively farmed field. There are no nearby features.

OREGON STATE PLANE COORDINATE, North Zone, NAD 83(91), International Feet:

N = 809118.64
E = 8733828.10

FIRM: William R. Wells, PLS
P.O. Box 1696
Pendleton, OR 97801

COMPASS DECLINATION: 18° East

Surveyor's Seal

Witnesses: Jason Wells, LSIT
Brian Cole

/5N35X17

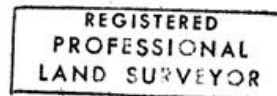

William R. Wells

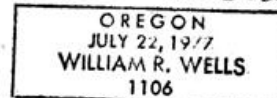

Renews 6/30/06

05-112-C