

OREGON CORNER RESTORATION FORM

COUNTY: Umatilla DATE: 01/13/05

CORNER DESIGNATION: 5N35, Z-21, The Southeast Corner of Section 35.

PREVIOUS RENEWALS/SURVEYS ETC.:

Corner originally established by Odell & Lewis, under GLO Contract No. 110, dated February 7, 1865. Notes state: Set post Standard Cor. for Secs. 35 & 36; drove charred stake, dug pits and raised mound as per instructions.

In Record of Private Surveys, Survey No. 194, the corner was recovered by Geary Kimbrell states: "a point 212 lks N of corner of fences running East and West and North. There is also some rock at the fence corner evidently put there to perpetuate the corner". The corner was apparently disputed at the time of Kimbrell's survey. Kimbrell further states: "I consider the evidence in favor of the corner as standing at the fence corner too strong to set aside and therefore accept the fence corner as the S.W. Corner of Sec. 36 T5N., R35E., W.M. Mr. Sam's, being dissatisfied with the survey at this juncture we discontinue further survey".

MONUMENT AND ACCESSORIES FOUND: Field intersection with field lines and berms running East-West and North. There is also a 4" diameter steel post and a set stone 20" by 6" by 2", with no visible marks. The stone is wrapped with wire.

MONUMENT MARKING DETAIL:

SC
T5N R35E
S35 | S36
2005
PLS 1106

MONUMENT SET:

I accept the found stone as the corner and set a 2 1/2" brass cap on a 2 1/2" x 30" galvanized iron pipe 24" in the ground, marked as shown in Monument Marking Detail. Buried stone on West side of new monument.

New accessories:

A silver deep-1 magnet buried 24" below ground bears North 67° East, 50.7 feet.
A purple deep-1 magnet buried 24" below ground bears South 23 1/2° East, 55.8 feet.
A blue deep-1 magnet buried 24" below ground bears South 73° West, 62.1 feet.
An orange deep-1 magnet buried 24" below ground bears North 22° West, 53.1 feet.
Buried bearing object signs with the deep-1 magnets. A 4" diameter iron post, about 8 feet high, bears Northwest, 2.5 feet from corner monument. Attached "witness" sign to the 4" post.

LOCATION AND COMMENTS:

At a 3 way field intersection with field lines running North-East-West.

OREGON STATE PLANE COORDINATE, North Zone, NAD 83(91), International Feet:

N = 806343.44

E = 8739125.71

FIRM: William R. Wells, PLS
P.O. Box 1696
Pendleton, OR 97801

COMPASS DECLINATION: 18° East

Witnesses: Jason Wells, LSIT
Brian Cole

/5N35Z21

Surveyor's Seal

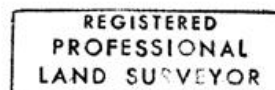

William R. Wells

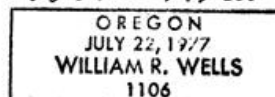

Renews 6/30/06

05-112-C