

OREGON CORNER RESTORATION FORM

COUNTY: Umatilla. DATE: 03/12/08

CORNER DESIGNATION: Z-23, The South One-Quarter Corner of Section 36, Township 6 North, Range 36 East, W.M..

PREVIOUS RENEWALS/SURVEYS ETC.: Corner originally established by Odell & Lewis under GLO Contract No. 110, dated February 7, 1865. Notes state: Set 1/4 Sec. post. Drove charred stake; dug pits; raised mound, as per instructions.

John Kimbrell, in his survey recorded at Book 1, Page 492, Record of Private Surveys, surveyed North from this corner but does not state what was found for the corner.

MONUMENT AND ACCESSORIES FOUND: None.

MONUMENT MARKING DETAIL:

T6N R36E
1 S36
4 S1
T5N
2008
PLS 1106

MONUMENT SET: I reestablished this corner by holding the old N-S field berm with fence remains for departure. For latitude, I developed mean ratio between Kimbrell's and our measurements between the Southeast and Northeast corners of Section 36 and between the East and West one-quarter corners of Section 36. I applied this mean ratio to Kimbrell's measurement between the North and South one-quarters of Section 36, resulting in a factored distance of 5333.90 feet from the North one-quarter corner of Section 36 to the South one-quarter corner. At the reestablished corner point, set a 2 3/8" brass cap on a 1 1/4" x 30" galvanized iron pipe with cap 8 inches below ground level on a stepped field berm. The monument is marked as shown in "Monument Marking Detail".

New accessories:

A 5/8" x 24" rebar with a red plastic cap marked "OR PLS 1106, WA PLS 17372", bears North 09° East, 27.4 feet.

A blue deep-1 magnet bears South 59° West, 32.1 feet.

A 5/8" x 24" rebar with a red plastic cap marked "OR PLS 1106, WA PLS 17372", bears South 05 1/2° West, 24.5 feet.

An orange deep-1 magnet bears North 52 1/2° West, 28.9 feet.

All deep-1 magnets are buried 24" below ground level with bearing object signs. Wired bearing object signs to the rebars accessories. Set steel fence post 1 foot North of corner and attached witness sign.

LOCATION AND COMMENTS: Corner is located in a field berm bank between fields. Corner is 2 feet East of top of bank, in old fence line with a few leaning posts remaining, (hit pieces of fence wire when digging monument hole). Old fence line and berm are curving in this area.

OREGON STATE PLANE COORDINATE, North Zone, NAD 83(91), International Feet:

N = 839565.25

E = 8772637.02

FIRM: Wells Surveying

P.O. Box 1696

Pendleton, OR 97801

COMPASS DECLINATION: 18° East

Surveyor's Seal

Witnesses: Jason Wells, LSIT

\6N36Z23

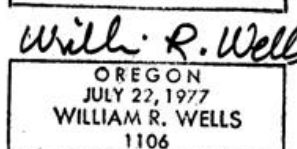
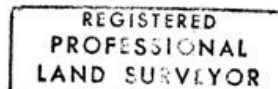

09-10-c