

OREGON CORNER RESTORATION FORM

Section 10 Township 5N Range 36E
 County Umatilla Date: May 22, 2012

Corner Designation: 5N36G17

Condition Report Only
 Not found
 x Remonumented
 Unrecorded
 x Surveyed in
 x Referenced out

Quarter corner common to sections 10 and 11, T5N, R36E, W.M., Umatilla County, Oregon.

Previous Renewals / Surveys, etc.

Corner was originally set by Odell and Lewis under contract No. 110 dated February 7, 1865. Their record reads: Set 1/4 Sec. post. Drove charred stake, dug pits, & raised mound as per instructions.

Monument and Accessories found: (condition and source)
 None. The point falls in a farmed field.

DIAGRAM

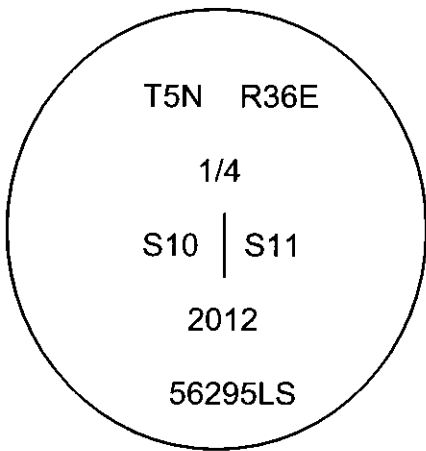

- ⊙ = Brass cap.
- = Rebar reference.
- x = Steel guard post.

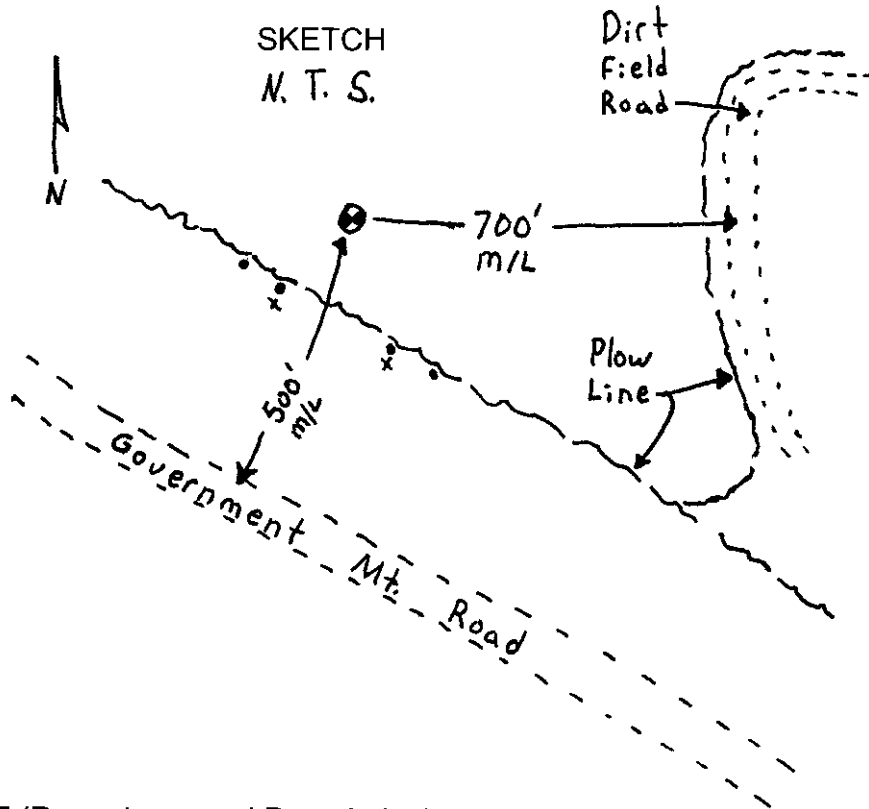

MONUMENT (S) AND ACCESSORIES SET (Procedures and Description)

Set a 1 1/2" x 30" galvanized iron pipe with a 2 3/8" brass cap stamped as shown in the diagram above 2 feet below the surface of a plowed field at the proportionate point.

For references, I set four 5/8" by 24" iron rebars with 1 1/8" orange plastic caps stamped WTS and 56295LS as described below at the toe of the plow berm on the S. edge of the field:
 an iron rebar bears S37°15'28"W, 133.06 feet;
 an iron rebar bears S21°14'55"W, 128.20 feet;
 an iron rebar bears S11°11'03"E, 152.23 feet;
 an iron rebar bears S23°39'24"E, 180.72 feet;

The monument was set and references were tied using Trimble R7/R8 RTK GPS.

Location and comments
 NAD 83/1991 State Plane Coordinate
 Oregon North Zone
 N = 831321.88 ift
 E = 8764647.61 ift

Compass Declination

Surveyors Seal

RECEIVED BY:
 Umatilla County Surveyor
 Date: 6/5/2012
 Rec'd By: A. Oles
 No. 12-088-C

Firm / Agency
 Witness Tree Surveying
 Address
 P.O. Box G
 Pilot Rock, Or. 97868
 Party Chief
 Stephen K, Haddock

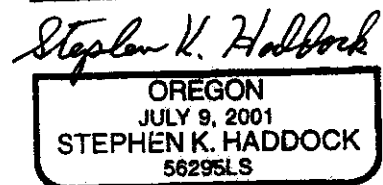
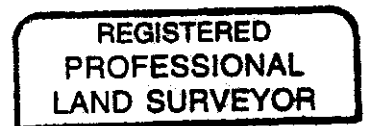

RENEWAL DATE 6-30-13