

# OREGON CORNER RESTORATION FORM

Section 14 Township 5N Range 36E  
 County Umatilla Date: November 21, 2011

Corner Designation: 5N36N17

Corner common to sections 14, 15, 22, and 23,  
 T5N, R36E, W.M., Umatilla County, Oregon.

Condition Report Only  
 Not found  
 Remonumented  
 Unrecorded  
 Surveyed in  
 Referenced out

Previous Renewals / Surveys, etc.

Corner was originally set by Odell and Lewis under contract No. 110 dated February 7, 1865. Their record reads: Set post corner for secs. 14, 15, 22 and 23. Drove charred stake, dug pits, raised mound, as per instructions; John Arnold in the Record of Privat Surveys Book 1, Page 170 states found stone over end of decayed alder stake. Fences run N. S. and E., Set basalt stone 17x8x7 ins. mkd. 3 notches on S. and 2 notches on E corners; Willard Bradley in the Record of Private Surveys Book 2, Page 269 states: Stone mon. in fence cor.; Victor McLind under survey 82-38-A states: Set 1/2" Steel Rod with 1" plastic cap stamped LS934 at fence corner with fences S. and E.;

Monument and Accessories found: ( condition and source )

The 1/2"x30" iron rebar with a faded plastic cap stamped LS934 at the fence corner.

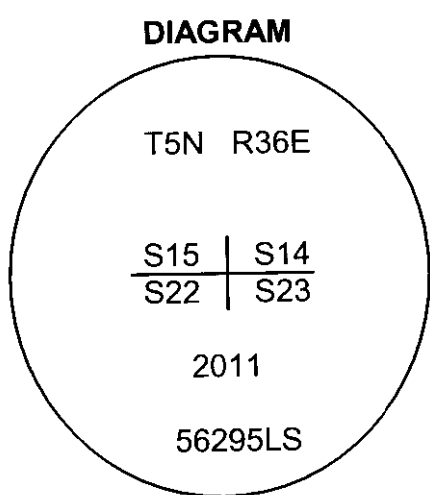

⊙ = Brass cap.  
 ● = Rebar reference.

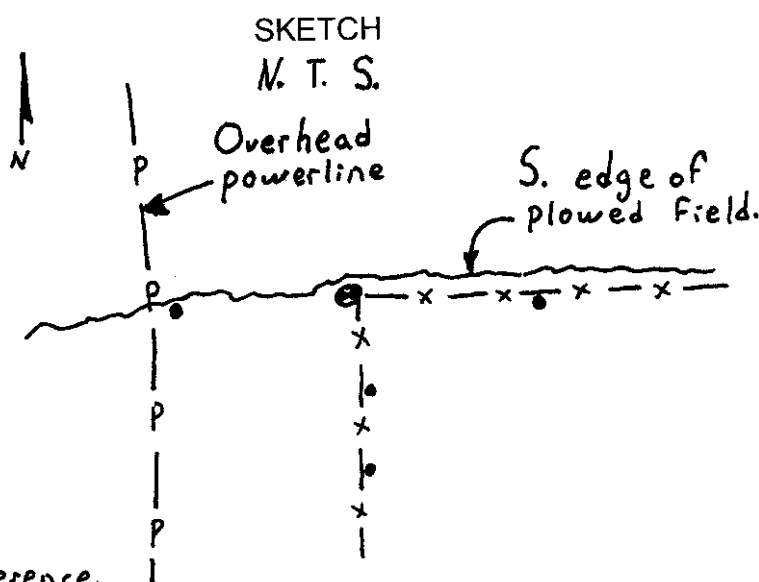

MONUMENT (S) AND ACCESSORIES SET (Procedures and Description)

I set a 2 1/4" brass cap on a 1 1/2"x30" galvanized iron pipe over the monument by McLind. The brass cap is stamped as shown in the diagram above.

For references: I set 4, 5/8"x24" iron rebars with orange plastic caps stamped WTS and 56295LS as described below:

- An iron rebar bears S81°22'17"W 38.83, feet in the south edge of a plow berm;
- An iron rebar bears S0°23'14"E, 57.71 feet under the existing fence;
- An iron rebar bears S0°54'15"E, 115.56 feet under the existing fence;
- An iron rebar bears N87°54'40"E, 80.08 feet under the existing fence;

The monument and references were tied using a Trimble R7/R8 RTK GPS system.

Location and comments  
 NAD 83/1991 State Plane Coordinate  
 Oregon North Zone  
 N = 823462.28 ift  
 E = 8764852.17 ift

Compass Declination

Surveyors Seal

RECEIVED BY:  
 Umatilla County Surveyor  
 Date: 6/5/2012  
 Rec'd By: A. Res  
 No. 12-088-C

Firm / Agency  
 Witness Tree Surveying  
 Address  
 P.O. Box G  
 Pilot Rock, Or. 97868  
 Party Chief  
 Stephen K, Haddock

REGISTERED  
 PROFESSIONAL  
 LAND SURVEYOR

*Stephen K. Haddock*

OREGON  
 JULY 9, 2001  
 STEPHEN K. HADDOCK  
 56295LS

RENEWAL DATE 6-30-13