

OREGON CORNER RESTORATION FORM

Section 1 Township 5N Range 36E
 County Umatilla Date: May 10, 2012

Corner Designation: 5N36C25

Condition Report Only
 Not found
 x Remonumented
 Unrecorded
 Surveyed in
 x Referenced out

Quarter corner common to section 1, T5N, R36E and section 6, T5N, R37E, W.M., Umatilla County, Oregon.

Previous Renewals / Surveys, etc.

Corner originally set by Deputy Surveyors Odell & Lewis under contract No. 110 dated February 7th, 1865. Their record reads: Set 1/4 sec. post, drove charred stake, dug pits & raised mound, as per instructions. In the record of private surveys, Book 1, Page 374, (Survey 99), John Kimbrell adopted the fence corner as the best available evidence.

Monument and Accessories found: (condition and source)

A long term possessory line with plow berms south and east. The remains of a fence are in the berm.

DIAGRAM

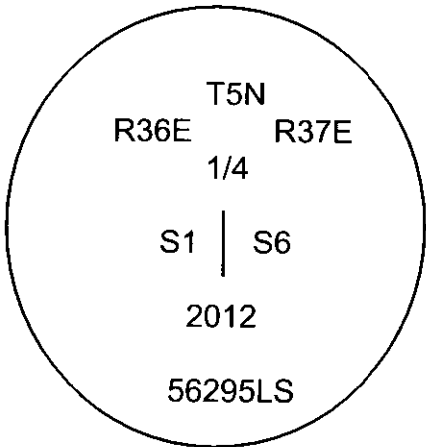

⊗ = Brass cap.
 ● = Rebar reference.

SKETCH

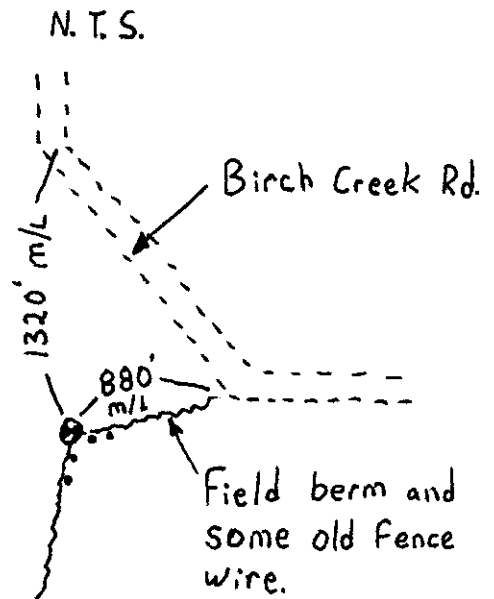

MONUMENT (S) AND ACCESSORIES SET (Procedures and Description)

At the corner point I set a 1 1/2" x 30" galvanized iron pipe with a 2 3/8" brass cap stamped as shown in the diagram above 2 feet below the surface.

For references, I set four 5/8" by 24" iron rebars with 1 1/8" orange plastic caps stamped WTS and 56295LS 2 feet below the surface as described below:

- a rebar bears N80°11'37"E, 30.12 feet;
- a rebar bears S74°41'45"E, 12.67 feet;
- a rebar bears S3°54'00"W, 22.29 feet;
- a rebar bears S10°23'23"W, 36.01 feet;

The monument and references were tied using a Trimble R7/R8 RTK GPS system.

Location and comments
 NAD 83/1991 State Plane Coordinate
 Oregon North Zone
 N = 837053.70 ift
 E = 8775225.59 ift

Compass Declination

Surveyors Seal

RECEIVED BY:
 Umatilla County Surveyor
 Date: 6/5/2012
 Rec'd By: A. [Signature]
 No. 12-088-C

Firm / Agency
 Witness Tree Surveying
 Address
 P.O. Box G
 Pilot Rock, Or. 97868
 Party Chief
 Stephen K, Haddock

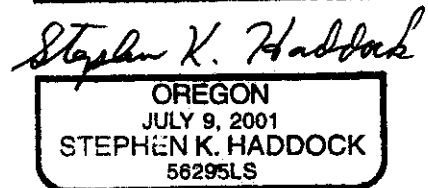
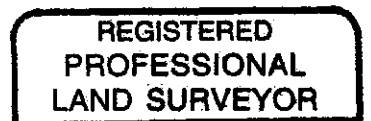

RENEWAL DATE 6-30-13