

USDA-FOREST SERVICE

Index File No. Z-23

CORNER RECORD (SEARCH)
(Ref. FSM 7151.4)

Tract or Survey No. _____ Cor. No. 1/4 Cor. _____

T 5S R. 29E.

R.D. Ukiah County Umatilla

Merid. Willamette

N.F. Umatilla State Oregon

CORNER DIAGRAM

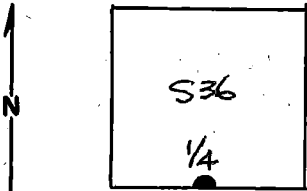

DESCRIBE CORNER MONUMENT FOUND

NONE

DESCRIBE BEARING TREES OR OTHER OFFICIAL ACCESSORIES FOUND

Douglas Fir, 16" Dia., BRS. S84¹⁰/₂°W., 35.6 Ft. Distance.
Rotted Stump, 26" Dia., BRS. N20⁰°E., 18.5 Ft. Distance.

PHOTO IDENTIFICATION DATA

Photo No. _____

Filed At. _____

Object Ident. _____

Ident. By _____

Signature

PLANE COORDINATE POSITION DATA

State _____ Zone _____

X _____

Y _____

Estab. By _____

Signature

DESCRIBE CORNER LOCATION RELATIVE TO NEAR-BY FEATURES, ALSO HOW TO REACH CORNER

Corner lies just South of Road along Std. parallel and is visible from same.

PLS

346

9/79

Title

Division

Headquarters

Date

7100-52-(3/68)

CORNER RECORD (PERPETUATION)

MONUMENT: DESCRIBE NEW MONUMENT SET, OR WORK DONE TO PRESERVE EXISTING MONUMENT

Set 32" X 2" Flanged iron pipe with brass cap marked:

SC
T5S R29E
1/4 S36
1979
PLS 346

9

ACCESSORIES: DESCRIBE NEW BT'S WITNESS OBJECTS ETC. ESTABLISHED, OR WORK DONE TO PRESERVE EXISTING EVIDENCE

Douglas Fir, 10" Dia., BRS. N27⁰W., 33.6 Ft. Distance.
Larch, 11" Dia., BRS. N15¹⁰₂E., 20.2 Ft. Distance.
6' Iron Fence Post with "Attention" sign within 5' of Corner.

10

Work Done By Wayne O. Harris Title PLS Date 9/79 State Registration No. 346
or Agency
Certified Cor. Record Prepared? YES NOX Filed At: Umatilla Co. Surveyor Office Date

11

REMARKS

12

Index File No. Z-23 T.5S R.29E W. M. Tract or Surv. No. Cor. 1/4 S36 13.
U.S. G.P.O. 1977-725-576/586

USDA-FOREST SERVICE

Index
File No. Z-23

CORNER RECORD (SEARCH)

(Ref. FSM 7151.4)

2

Tract or
Survey No. _____ No. _____

T 53S R. 29E

R.D. Ukiah County _____

Merid. Willamette

N.F. Umatilla State Oregon

CORNER DIAGRAM

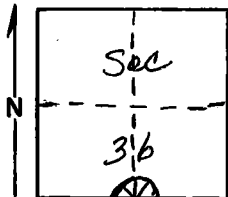

DESCRIBE CORNER MONUMENT FOUND

Material: None

DESCRIBE BEARING TREES OR OTHER OFFICIAL ACCESSORIES FOUND

A 16" Doug. fir in east-west fence line. I chopped out scar on east face and found 1/4 scribed.

A 36" pond pine stump sits in proper location for other B.T. No original scribing visible. Letter "S" or figure "5" has been carved on it with what would appear to be a knife

PHOTO IDENTIFICATION DATA

Photo No. _____

Filed At. _____

Object Ident. _____

Ident. By _____

Signature

PLANE COORDINATE POSITION DATA

State _____ Zone _____

X _____

Y _____

Estab. By _____

Agency

DESCRIBE CORNER LOCATION RELATIVE TO NEAR-BY FEATURES, ALSO HOW TO REACH CORNER

Old road follows the east-west fence.

Signature

T. Hollamon, Engr. Tech.

Title

Division

Headquarters

Date

8-29-78

7100-52-(3/68)

CORNER RECORD (PERPETUATION)

MONUMENT : DESCRIBE NEW MONUMENT SET, OR WORK DONE TO PRESERVE EXISTING MONUMENT

9

ACCESSORIES : DESCRIBE NEW BT'S WITNESS OBJECTS ETC. ESTABLISHED, OR WORK DONE TO PRESERVE EXISTING EVIDENCE

I placed a blank B.T. tag on the pine stump. Also placed a blank B.T. tag and an attention poster on the fir B.T.

10

Work Done By. _____ Title _____ Date _____ State Registration No. or Agency _____

Certified Cor. Record Prepared ? Yes No Filed At: _____ Date _____ 11

REMARKS

12

Index File No. T. R. M. Tract or Surv. No. Cor. 13