

Index File No. A-1
 T 5 S. R. 31 E.
 Merid. Willamette

CORNER RECORD (SEARCH)

(Ref. FSM 7151.4)

Tract or Survey No. _____ Cor. No. _____

R.D. Ukiah County Umatilla
 N.F. Umatilla State Oregon

CORNER DIAGRAM

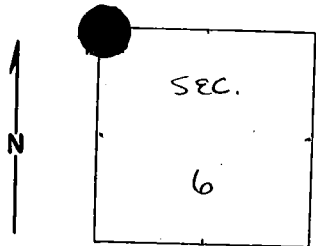

DESCRIBE CORNER MONUMENT FOUND

Material: Stone mound

Markings: None visible (GLO notes, do not mention markings)

Monumented

DESCRIBE BEARING TREES OR OTHER OFFICIAL ACCESSORIES FOUND

North-South fence approximately 20 feet west of the mound. The SW and NW BT's still stand. The SE and NE BT's have been cut. The stumps remain. Visible scribing on all four. Mound is 20 feet north of middle of stream bed.

PHOTO IDENTIFICATION DATA

Photo No. _____
 Filed At. _____
 Object Ident. _____
 Ident. By _____
Signature

PLANE COORDINATE POSITION DATA

State _____ Zone _____
 X _____
 Y _____
 Estab. By _____
Agency

DESCRIBE CORNER LOCATION RELATIVE TO NEAR-BY FEATURES, ALSO HOW TO REACH CORNER

There is a primitive road on Hogback N.W. (See Sugarbowl Creek 7.5 minute quad. map)

Signature T. Hollamon Title Engr, Tech, Division _____ Headquarters _____ Date 4-21-76

CORNER RECORD (PERPETUATION)

MONUMENT: DESCRIBE NEW MONUMENT SET, OR WORK DONE TO PRESERVE EXISTING MONUMENT

ACCESSORIES : DESCRIBE NEW BT'S WITNESS OBJECTS ETC. ESTABLISHED, OR WORK DONE TO PRESERVE EXISTING EVIDENCE

I placed a blank BT tag on each of the BT's and BT stumps.

Work Done By _____ Title _____ Date _____ State Registration No. or Agency _____

Certified Cor. Record Prepared ? Yes No Filed At: _____ Date _____

REMARKS

Index File No. T. R. M. Tract or Surv. No. Cor.