

Index File No. J-13

CORNER RECORD (SEARCH)

(Ref. FSM 7151.4)

Tract or Survey No. _____ Cor. No. _____

T 5 S R. 30 E

R.D. Ukiah County Umatilla

Merid. Willamette

N.F. Umatilla State Oregon

CORNER DIAGRAM

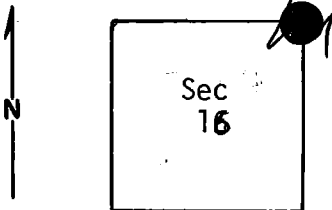

DESCRIBE CORNER MONUMENT FOUND

Basalt stone, generally fits GLO description, 6" above ground, good condition; markings not legible.

no record of Monumentation!

DESCRIBE BEARING TREES OR OTHER OFFICIAL ACCESSORIES FOUND

BT 36" PP bears N.30°W., 73 links. Scribed T5S, R30E, S9, BT. Tree has 2 BT metal tags and red painted ring around it. 14" uprooted, rotted pine stump bears N. 80°E, 29 links (approx.) 48" partially rotted (hollowed out on W side) pine stump bears S. 38°W, approx. 78 links. BT 34" PP bears S50°E, approx. 15 links. Scribing not legible without opening scar. Tree has 1 BT metal tag, 1 location poster and a red painted ring around it.

PHOTO IDENTIFICATION DATA

Photo No. _____
 Filed At. _____
 Object Ident. _____
 Ident. By _____
Signature

DESCRIBE CORNER LOCATION RELATIVE TO NEAR-BY FEATURES, ALSO HOW TO REACH CORNER

From New Western Route Rd. go southerly on Road S-420 about 2.1 mi. to a point approx. 300' N. of Sec. line between Sec. 9 and 16. Thence Southeasterly on a logging road for about .2 mile. Witness tree is visible a bout 60' E. of road. Location poster and Sec. line board on the W (50') of Road S-420 for this corner.

PLANE COORDINATE POSITION DATA

State _____ Zone _____
 X _____
 Y _____
 Estab. By _____
Agency

Signature	Title	Division	Headquarters	Date	7100-52-(3/68)
T. Hollamon	Eng Tech	Umatilla	S.O.	9/19/73	

CORNER RECORD (PERPETUATION)

MONUMENT: DESCRIBE NEW MONUMENT SET, OR WORK DONE TO PRESERVE EXISTING MONUMENT

ACCESSORIES : DESCRIBE NEW BT'S WITNESS OBJECTS ETC. ESTABLISHED, OR WORK DONE TO PRESERVE EXISTING EVIDENCE

Work Done By _____ Title _____ Date _____ State Registration No. or Agency _____
Certified Cor. Record Prepared? Yes No Filed At: _____ Date _____

REMARKS

Corner satisfactory for monumentation.

Index File No. J-13 T. R. M. Tract or Surv. No. Cor.