

USDA-FOREST SERVICE

Index File No. J-21

CORNER RECORD (SEARCH)

(Ref. FSM 7151.4)

Tract or Survey No. _____ Cor. No. _____

T 5S R. 30E

R.D. NORTH FORK J.D. County UMATILLA

Merid. WILLAMETTE

N.F. UMATILLA State OREGON

CORNER DIAGRAM

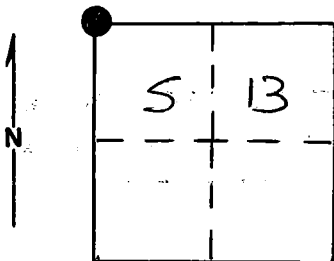

DESCRIBE CORNER MONUMENT FOUND

Found 2½" brass cap monument marked:
in a mound of stone.

T5S	R30E
S 11	S 12
S 14	S 13
1974	
PLS 644	

DESCRIBE BEARING TREES OR OTHER OFFICIAL ACCESSORIES FOUND

A 13" Ponderosa Pine N28°E, 12.2 ft. live and vigorous with scribes visible. A 10" Ponderosa Pine S13°E, 57.7 ft. dead and down with scribes visible. A 22" Ponderosa Pine snag S38°E, 10 lks. with scribes visible. A 29" Ponderosa Pine S16°W, 54.8 ft. live and vigorous with scribes visible. A 24" Ponderosa Pine N36°W, 77.1 ft. live and vigorous with scribes visible.

PHOTO IDENTIFICATION DATA

Photo No. 1487-26
Filed At. Ranger Office
Object Ident. Corner
Ident. By D.I. Griffith
Signature

DESCRIBE CORNER LOCATION RELATIVE TO NEAR-BY FEATURES, ALSO HOW TO REACH CORNER

Corner falls on open timbered flat next to an old fencejack in the remains of a North-South fenceline approximately 500 feet East of the 035 road.

PLANE COORDINATE POSITION DATA

State _____ Zone _____
X _____
Y _____
Estab. By _____

Signature _____
Agency _____

Title _____ Division _____ Headquarters _____ Date _____

Signature _____ SURVEYOR

Date 9-7-88 FS-7100-52 (3/68)

CORNER RECORD (PERPETUATION)

MONUMENT: DESCRIBE NEW MONUMENT SET, OR WORK DONE TO PRESERVE EXISTING MONUMENT

NONE

ACCESSORIES : DESCRIBE NEW BT'S WITNESS OBJECTS ETC. ESTABLISHED, OR WORK DONE TO PRESERVE EXISTING EVIDENCE

New BT:

A 12 inch diameter Ponderosa Pine bears S1°E, 28.30 feet marked T5S R30E S13 BT

Painted a 6 inch red band around all bearing trees and attached 54-3 and 54-9 signs.
Attached 54-9 sign to existing steel fencepost approximately 5 feet North of corner.

Work Done By D.I. Griffith Title Surveyor Date 9-2-88 State Registration No. OPLS 644
or Agency

Certified Cor. Record Prepared ? Yes No Filed At: Umatilla County Surveyor Office Date 10-88

REMARKS

Witnesses: Rick Robinson and Jeff Petersen

Index File No. J-21 T.55 R.30E WM. Tract or Surv. No. Cor.

Index J-21 **CORNER RECORD (SEARCH)** Tract or Survey No. _____ Cor. No. _____
 File No. 5 S (Ref. FSM 7151.4) _____
 T 5 S R. 30 E R.D. Ukiah County Umatilla
 Merid. Willamette N.F. Umatilla State Oregon

CORNER DIAGRAM

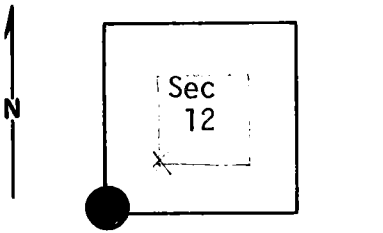

DESCRIBE CORNER MONUMENT FOUND

Brass Cap! see Monumentation F. 10.

DESCRIBE BEARING TREES OR OTHER OFFICIAL ACCESSORIES FOUND

28" PP w/blaze on NW face. Scribed R30E, S13.
 BLM ~~boundary~~ tree poster on E side of tree and old FS location poster on W side.
 30" PP w/blaze on N side. Scribing visible inside blaze. *B.T.*
 Poster 54-3 on tree.

PHOTO IDENTIFICATION DATA

Photo No. _____
 Filed At. _____
 Object Ident. _____
 Ident. By _____
 Signature _____

DESCRIBE CORNER LOCATION RELATIVE TO NEAR-BY FEATURES, ALSO HOW TO REACH CORNER

PLANE COORDINATE POSITION DATA

State _____ Zone _____
 X _____
 Y _____
 Estab. By _____
 Agency _____

Signature	Title	Division	Headquarters	Date	7100-52-(3/68)
<u>R. Moore</u>	<u>Eng. Tech.</u>	<u>Umatilla</u>	<u>S.O.</u>	<u>8/73</u>	

CORNER RECORD (PERPETUATION)

MONUMENT: DESCRIBE NEW MONUMENT SET, OR WORK DONE TO PRESERVE EXISTING MONUMENT

ACCESSORIES : DESCRIBE NEW BT'S WITNESS OBJECTS ETC. ESTABLISHED, OR WORK DONE TO PRESERVE EXISTING EVIDENCE

Work Done By _____ **Title** _____ **Date** _____ **State Registration No. or Agency** _____

Certified Cor. Record Prepared ? Yes No **Filed At:** _____ **Date** _____

REMARKS

Index File No. *J-21* **T.** _____ **R.** _____ **M.** _____ **Tract or Surv. No.** _____ **Cor.** _____