

Index File No. J-23 CORNER RECORD (SEARCH) (Ref. FSM 7151.4) Tract or Survey No. \_\_\_\_\_ Cor. No. \_\_\_\_\_  
 T 5 S R. 30 E R.D. Ukiah County Umatilla  
 Merid. Willamette N.F. Umatilla State Oregon

CORNER DIAGRAM

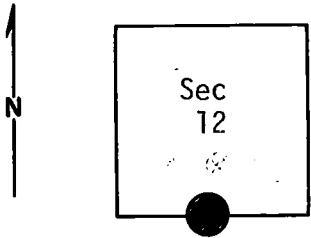

DESCRIBE CORNER MONUMENT FOUND

*Brass Cap! see Monumentation File,*

DESCRIBE BEARING TREES OR OTHER OFFICIAL ACCESSORIES FOUND

Mound of stones 2' East of fence intersection from which a 40" dia pine stump 12' tall bears S. 70°W. ~~Tree~~ *Stump* has blaze on NE face. Scribing: 1/4 S B.T.  
 20' west of stone mound is 6" pine tree with old F.S. location poster (not readable).  
 30' south of stone mound is pine tree with NF boundary sign on East face.

PHOTO IDENTIFICATION DATA

Photo No. \_\_\_\_\_  
 Filed At. \_\_\_\_\_  
 Object Ident. \_\_\_\_\_  
 Ident. By \_\_\_\_\_  
*Signature*

PLANE COORDINATE POSITION DATA

State \_\_\_\_\_ Zone \_\_\_\_\_  
 X \_\_\_\_\_  
 Y \_\_\_\_\_  
 Estab. By \_\_\_\_\_  
*Agency*

DESCRIBE CORNER LOCATION RELATIVE TO NEAR-BY FEATURES, ALSO HOW TO REACH CORNER

Signature B. Moore Title Eng, Tech, Division Umatilla Headquarters S, O, Date 8/73 7100-52-(3/68)

**CORNER RECORD (PERPETUATION)**

**MONUMENT: DESCRIBE NEW MONUMENT SET, OR WORK DONE TO PRESERVE EXISTING MONUMENT**

9

**ACCESSORIES : DESCRIBE NEW BT'S WITNESS OBJECTS ETC. ESTABLISHED, OR WORK DONE TO PRESERVE EXISTING EVIDENCE**

10

Work Done By \_\_\_\_\_ Title \_\_\_\_\_ Date \_\_\_\_\_ State Registration No. or Agency \_\_\_\_\_

Certified Cor. Record Prepared ? Yes No Filed At: \_\_\_\_\_ Date \_\_\_\_\_

**REMARKS**

12

Index File No. *J-23* T. R. M. Tract or Surv. No. Cor. 13