

Index File No. R-21

CORNER RECORD (SEARCH)

(Ref. FSM 7151.4)

Tract or Survey No. _____ Cor. No. _____

T 5S R. 30E

R.D. N. FORK JOHN DAY County UMATILLA

Merid. WILLAMETTE

N.F. UMATILLA State OREGON

CORNER DIAGRAM

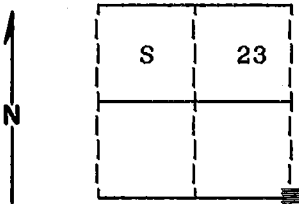

DESCRIBE CORNER MONUMENT FOUND

Found a 2½" standard BLM brass cap monument marked as shown: in small mound of stone.

T5S R30E

S 23	S 24
S 26	S 25
1978	

DESCRIBE BEARING TREES OR OTHER OFFICIAL ACCESSORIES FOUND

Found a 32" Ponderosa Pine stump S28½°E 193 lks with scribes visible. Found a 13" Ponderosa Pine N9°E, 63 lks live and vigorous with blaze evident. Found a 18" Ponderosa Pine S14°E, 125 lks, live and vigorous with blaze evident. Found a 10" Ponderosa Pine S85°W, 73 lks, live and vigorous with blaze evident. Found a 12" Ponderosa Pine N69½°W, 121 lks, dead and standing with blaze evident.

PHOTO IDENTIFICATION DATA

Photo No. _____
 Filed At. _____
 Object Ident. _____
 Ident. By _____
 Signature _____

DESCRIBE CORNER LOCATION RELATIVE TO NEAR-BY FEATURES, ALSO HOW TO REACH CORNER

Corner falls approximately 800 feet South of the end of the 5309 road.

PLANE COORDINATE POSITION DATA

State _____ Zone _____
 X _____
 Y _____
 Estab. By _____

Signature *[Handwritten Signature]* Agent

Title SURVEYOR

Division _____

Headquarters _____

Date 5-10-89

FS-7100-52 (9/68)

2

3

6

7

8

4

5

CORNER RECORD (PERPETUATION)

MONUMENT: DESCRIBE NEW MONUMENT SET, OR WORK DONE TO PRESERVE EXISTING MONUMENT

Rebuilt mound of stone around monument,
3 ft. base to top of cap.

9

ACCESSORIES : DESCRIBE NEW BT's WITNESS OBJECTS ETC. ESTABLISHED, OR WORK DONE TO PRESERVE EXISTING EVIDENCE

New Bearing Object

A 1/2" x 30" iron pin with plastic cap marked "BGA MARKER" bears N8°W, 41.20 feet
Pin is set at the North end of the gate on an existing North-South fence line.

Painted a 6 inch red band around all bearing trees and attached 54-3 and 54-9 signs.

Set a steel fencepost approximately 5 feet North with 54-9 and 54-2 signs attached.

10

Work Done By D.I. Griffith Title Surveyor Date 5-6-89 State Registration No. OPLS 644
or Agency

Certified Cor. Record Prepared ? No Filed At Umatilla Co Surveyor Office Date 5-89

11

REMARKS

Witnesses: Rick Robinson and Jeff Peterson

12

Index File No. R-21 T. 55 R. 30E WM. Tract or Surv. No. Cor. 13

Index

File No. R-21

CORNER RECORD (SEARCH)

(Ref. FSM 7151.4)

Tract or
Survey No. _____Cor.
No. _____T 5 S. R. 30 E.R.D. Ukiah County UmatillaMerid. WillametteN.F. Umatilla State Oregon

CORNER DIAGRAM

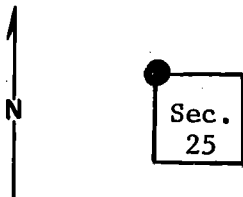

DESCRIBE CORNER MONUMENT FOUND

Stone mound, 4 ft. diam., 4" above ground; condition - fair to poor.

Monumented By BLM, 1978

Mound somewhat scattered. No evidence of corner stone.

DESCRIBE BEARING TREES OR OTHER OFFICIAL ACCESSORIES FOUND 2

A 32" p. pine stump, 12" high, bears S.28°E., approx. 130 ft. A small amount of scribing is faintly visible. There is an old B.T. tag on it. There is also a 23" p. pine stump, 4 ft. high, approx. 1 ft. southeast of the B.T. stump which is scribed T5S, R30E, S25. (Apparently a reference to the B.T.)

(cont. in block 12)

DESCRIBE CORNER LOCATION RELATIVE TO NEAR-BY FEATURES, ALSO HOW TO REACH CORNER 3

Stone mound sets in north-south fence (Forest boundary) about 4 ft. south of fence rock-jack. There is also a fence running west. It junctions with the N-S fence approx. 20 ft. north of stone mound.

A primitive road runs east-west 30 ft. north of stone mound, along top of ~~that~~ semi-open spur ridge.

PHOTO IDENTIFICATION DATA 6

Photo No. _____

Filed At. _____

Object Ident. _____

Ident. By _____

Signature 7PLANE COORDINATE POSITION DATA 8

State _____ Zone _____

X _____

Y _____

Estab. By _____

Agency 8

Signature

T. Hollamon

Title

Eng, Tech,

Division

Headquarters

Date

4/26/74

7100-52-(3/68)

5

CORNER RECORD (PERPETUATION)

MONUMENT : DESCRIBE NEW MONUMENT SET, OR WORK DONE TO PRESERVE EXISTING MONUMENT

ACCESSORIES : DESCRIBE NEW BT'S WITNESS OBJECTS ETC. ESTABLISHED, OR WORK DONE TO PRESERVE EXISTING EVIDENCE

Work Done By _____ Title _____ Date _____ State Registration No. or Agency _____
Certified Cor. Record Prepared ? Yes No Filed At: _____ Date _____

REMARKS

(Block 3 cont.)

Location poster on a 7" p. pine approx. 12 ft. east of stone mound.

No evidence of SW B.T. (only 2 B.T.'s were originally established.

Area north of corner is open ground.)

Index File No. T. R. M. Tract or Surv. No. Cor. 12 13