

USDA-FOREST SERVICE

Index File No. Q-2
 T 5S R. 31E
 Merid. Willamette

CORNER RECORD (SEARCH)

(Ref. FSM 7151.4)

R.D. Ukiah County Umatilla Tract or Survey No. Sec 19 Cor. S.W. 1/16
 N.F. Umatilla State Oregon

CORNER DIAGRAM

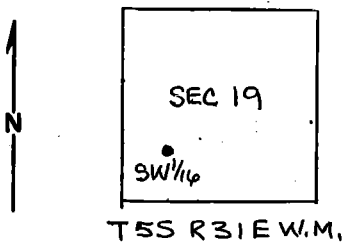

DESCRIBE CORNER MONUMENT FOUND

None

DESCRIBE BEARING TREES OR OTHER OFFICIAL ACCESSORIES FOUND

None

PHOTO IDENTIFICATION DATA

Photo No. _____
 Filed At. _____
 Object Ident. _____
 Ident. By _____
Signature

DESCRIBE CORNER LOCATION RELATIVE TO NEAR-BY FEATURES, ALSO HOW TO REACH CORNER

From the location marker on West side of road walk West 25'+ to corner.
 Corner is located 30' West of road in the thicket of small mixed timber.

PLANE COORDINATE POSITION DATA

State _____ Zone _____
 X _____
 Y _____
 Estab. By _____
Agency

Signature William R. Wells Title PLS 1106 Division _____ Headquarters _____ Date 8/12/79
 7100-52-(3/68)

CORNER RECORD (PERPETUATION)

MONUMENT: DESCRIBE NEW MONUMENT SET, OR WORK DONE TO PRESERVE EXISTING MONUMENT

Set a 2" x 30" galvanized iron pipe with a brass cap 29" in ground marked:
Set steel fence posts South and West of corner on
property line and attached signs 54-2 and 54-9.

T55 R31E
SW 1/16 S19
1979
PLS 1106

ACCESSORIES : DESCRIBE NEW BT'S WITNESS OBJECTS ETC. ESTABLISHED, OR WORK DONE TO PRESERVE EXISTING EVIDENCE

A 1 1/2" red fir bears N86°E 116.2 ft. to center, marked SW 1/16 S 19BT.
A 9 1/2" Tamarack bears N35°W 41.9 ft. to center, marked SW 1/16 S 19BT.
BT's have a lower blaze scribed BT with a brass washer stamped PLS 1106 nailed flush.
Attached signs 54-3 and ~~54-4~~ and painted red ring around BT's.

Work Done By William R. Wells Title PLS Date 8/12/79 State Registration No. 1106
or Agency

Certified Cor. Record Prepared ? Yes No Filed At Umatilla County Surveyor's Office Date _____

REMARKS

Note: This corner was established in error in 7/79 and bearing trees established. When the corner was established in its true position, scribing and signs were removed, from one BT referencing the erroneous position. From the correct corner position: A 9 1/2" red fir bears S89°E 87.8 ft. with open blaze.