

USDA-FOREST SERVICE

Index S-3

File No. 55 R. 31E

T Merid. Willamette

CORNER RECORD (SEARCH)

(Ref. FSM 7151.4)

Tract or Survey No. Sec 30

Cor. No. CN 1/16

R.D. Utah

Umatilla

County

Umatilla

N.F. Umatilla

Umatilla

State

Oregon

CORNER DIAGRAM

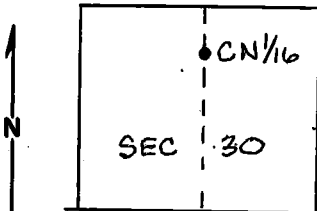

T55 R31E W.M.

DESCRIBE CORNER MONUMENT FOUND

None

DESCRIBE BEARING TREES OR OTHER OFFICIAL ACCESSORIES FOUND

None

PHOTO IDENTIFICATION DATA

Photo No. _____

Filed At. _____

Object Ident. _____

Ident. By _____

Signature

PLANE COORDINATE POSITION DATA

State _____ Zone _____

X _____

Y _____

Estab. By _____

Agency

DESCRIBE CORNER LOCATION RELATIVE TO NEAR-BY FEATURES, ALSO HOW TO REACH CORNER

The corner is located 300' West from the bottom of a dry creek in edge of small clearing.

Signature

William R. Wells

Title

PLS 1106

Division

Headquarters

Date

8/21/79

7100-52-(3/68)

CORNER RECORD (PERPETUATION)

MONUMENT: DESCRIBE NEW MONUMENT SET, OR WORK DONE TO PRESERVE EXISTING MONUMENT

Set a 2" x 30" galvanized iron pipe with a brass cap, 18" in ground with a mound of stone to the top marked:
 Set steel fence post on property line. South and East of corner and attached signs 54-2 and 54-9.

TSS R31E
 CN 1/16 S 30
 C
 1979
 PLS 1106

9

ACCESSORIES: DESCRIBE NEW BT'S WITNESS OBJECTS ETC. ESTABLISHED, OR WORK DONE TO PRESERVE EXISTING EVIDENCE

A 11" red fir bears N54° E 5.9 ft. to center scribed CN 1/16 S 30 BT.
 A 8 1/2" red fir bears S52 1/2° E 11.6 ft. to center scribed CN 1/16 S 30 BT.
 BT's have a lower blaze scribed BT with a brass washer stamped PLS 1106 nailed flush. Attached signs 54-3 and 54-4 and painted red ring around BT's.

10

Work Done By: William R. Wells Title PLS Date 8/21/79 State Registration No. 1106
 or Agency _____
 Certified Cor. Record Prepared? Yes No _____ Filed At: Umatilla County Surveyor's Office Date _____

11

REMARKS

NOTE: This corner was erroneously established in 7/79 and bearing trees established. When the corner was established in its true position, scribing and signs were removed from BT's referencing the erroneous position. From the correct corner position: A 11 1/2" red fir bears S86° E 227 ± feet with open blaze. A 11" red fir bears S78° E 210 ± feet with open blaze.

12