

OREGON CORNER RESTORATION FORM

Section 9 Township 5S Range 32E
 County Umatilla Date: October 25th, 2021

Corner Designation: 5S32E11

Condition report only
 Not Found

Quarter Corner common to Sections 4, and 9, T5S,
 R32E, W.M., Umatilla County, Oregon.

X Remonumented
 Unrecorded
 Surveyed In
X Referenced Out

Previous Renewals, Surveys, etc...

This corner was originally set by George S. Pershin under GLO contract 390 dated May 12th, 1881. His record reads: Set basalt stone 24x12x5 on NW slope for 1/4 sec. cor. A pine, 10 ins. Diam. Brs. N32°E 36 lks. Dist. A tamarack, 16 ins. Diam. Brs. S24°E, 100 lks. Dist.

Monument and accessories found: (condition and source)

A 29" DBH live Ponderosa Pine with no visible markings at record distance NE of the original stone. The original SE tamarack BT (now a stump) with overgrown blaze scar visible on top. Opening the stump revealed a complete set of reverse scribing grown into the old scribe marks. The original basalt stone 27"x11"x8", plainly marked 1/4 lying on its side in a mound of stone at the record point determined by the bearing trees.

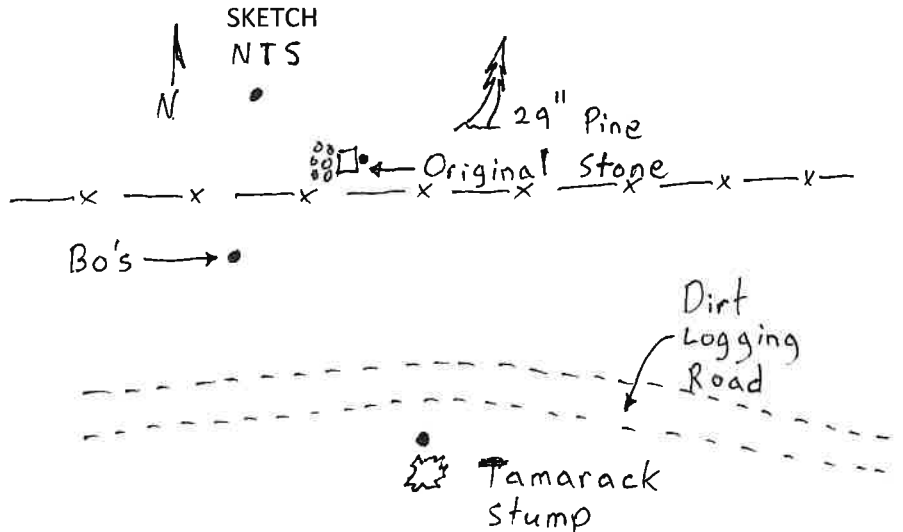
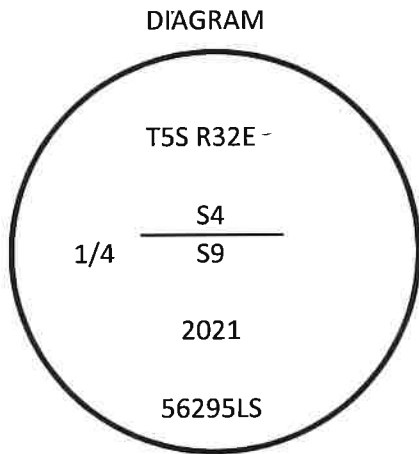

MONUMENT(S) AND ACCESSORIES SET (Procedures and Description)

At the position of the found original stone I reset the stone 21" in the ground with the 1/4 on the west face. I set a 5/8"x30" iron rebar with an orange plastic cap stamped WTS and 56295LS, S65°01'E 0.36 feet directly against the easterly side of the stone.

For references I set three 5/8" by 24" iron rebars with 1.25" orange plastic caps stamped WTS and 56295LS as described below:

- The original tamarack stump bears S14°02'06"E 66.00 feet to the center of the stump.
- A 29" Ponderosa Pine bears N55°31'54"E, 23.76 feet with a BT sign attached.
- An iron rebar bears S13°41'41"E 64.440 feet at the base of the tamarack BT stump;
- An iron rebar bears S29°41'58"W, 29.84 feet;
- An iron rebar bears N01°06'34"E 15.75 feet;

The monument was tied using a Trimble R8S RTK GPS Base - Rover pair.

Location and comments:

Compass Declination

Surveyor's Seal

RECEIVED BY:
Umatilla County Surveyor
 Date: 12/16/21
 Rec'd By: CT
 No. 21-145-B

Firm / Agency
 Witness Tree Surveying
 Address
 P.O. Box G
 Pilot Rock, OR 97868
 Party Chief
 Stephen K. Haddock

REGISTERED
 PROFESSIONAL
 LAND SURVEYOR

Stephen K. Haddock

OREGON
 JULY 9, 2001
 STEPHEN K. HADDOCK
 56295LS

RENEWS: 6-30-23